

From: Ramos, Christina M  
To: Subject: RE: Diridon help  
Date: Monday, October 5, 2020 11:11:55 AM  
Attachments: [image001.png](#), [image002.png](#), [image003.png](#)

Good Afternoon Roland,  
The attached document did not come from me or my office. Hopefully, you can find who sent it to you to send you the information you are looking for.

Christina Ramos, Chief of Staff  
Office of Councilmember Perez  
District 3, City of San Jose

From: Roland Lebrun  
Sent: Friday, October 2, 2020 2:04 PM  
To: Ramos, Christina M <[christina.m.ramos@sanjoseca.gov](mailto:christina.m.ramos@sanjoseca.gov)>; Perez, Raul <[Raul.Perez@sanjoseca.gov](mailto:Raul.Perez@sanjoseca.gov)>  
Subject: Re: Diridon help

[External Email]

Hi Christina,

Thank you for sharing the Downtown West design guidelines. This document is extremely useful from a transit integration perspective.

Could you please ask Google if they would be willing to share their massing model on slide 8 (attached and below)?

This would enable us to integrate their model into our elevated station concept and give us a head start on modifications to the concept to advance the integration of transit modes into the fabric of the Downtown West Design Vision.

Thanks again for all your help and have a nice weekend.

Roland.



From: Ramos, Christina M <[christina.m.ramos@sanjoseca.gov](mailto:christina.m.ramos@sanjoseca.gov)>  
Sent: Thursday, October 1, 2020 3:13 PM  
To: Roland Lebrun <[roland.lebrun@sanjoseca.gov](mailto:roland.lebrun@sanjoseca.gov)>; Perez, Raul <[Raul.Perez@sanjoseca.gov](mailto:Raul.Perez@sanjoseca.gov)>  
Subject: RE: Diridon help

Thanks for the clarification Roland. This question of this also came up in conversation, and at this time Google is not prepared to do anything other than weigh in as stakeholders, similar to the community. They haven't stated to me their preferred option selection. So I have no information to that. However, they stated their current focus is the EIR regarding Downtown West and they don't want to overshadow what is already in the works.

Christina Ramos, Chief of Staff  
Office of Councilmember Perez  
District 3, City of San Jose

From: Roland Lebrun  
Sent: Thursday, October 1, 2020 2:47 PM  
To: Ramos, Christina M <[christina.m.ramos@sanjoseca.gov](mailto:christina.m.ramos@sanjoseca.gov)>; Perez, Raul <[Raul.Perez@sanjoseca.gov](mailto:Raul.Perez@sanjoseca.gov)>  
Subject: Re: Diridon help

[External Email]

Hi Christina,

There appears to be a misunderstanding, specifically that no one is asking Google to lead the design.

Having said that, I think that it would be beneficial for all parties concerned if Google and the community were allowed to collaborate on alternative designs and work towards an outcome that everyone agrees on. This effort could be coordinated by the City of San Jose or a future Caltrain administration.

I hope this makes more sense.

Roland.

PS: I would definitely like to learn more about Google's preferred concept.

From: Ramos, Christina M <[christina.m.ramos@sanjoseca.gov](mailto:christina.m.ramos@sanjoseca.gov)>  
Sent: Thursday, October 1, 2020 12:23 PM  
To: Perez, Raul <[Raul.Perez@sanjoseca.gov](mailto:Raul.Perez@sanjoseca.gov)>; Roland Lebrun  
Subject: RE: Diridon help

Good Afternoon Roland,

After checking in with Google, they are not leading the design, nor are they working on the design. They would be a community stakeholder just like yourself. They do have a preferred concept, but they are not taking the lead on the DISC. Therefore, the community engagement process would be handled by the government entities leading the on the DISC.  
Hope that provides some clarity.

Christina Ramos, Chief of Staff  
Office of Councilmember Perez

District 3, City of San Jose

**From:** Perez, Raul <[Raul.Perez@sanjoseca.gov](mailto:Raul.Perez@sanjoseca.gov)>  
**Sent:** Thursday, September 24, 2020 5:36 PM  
**To:** Roland Lebrun <[REDACTED]> Ramos, Christina M <[christina.m.ramos@sanjoseca.gov](mailto:christina.m.ramos@sanjoseca.gov)>  
**Subject:** RE: Diridon help

Okay, I can ask for that.

Christina can you connect with Javier on this request.

Raul Perez  
Councilmember, District 3  
City of San Jose

**From:** [Roland Lebrun](mailto:Roland.Lebrun)  
**Sent:** Thursday, September 24, 2020 5:25 PM  
**To:** [Perez, Raul](mailto:Perez, Raul)  
**Subject:** Re: Diridon help

[External Email]

No, not just me (I am part of the community)

**From:** Perez, Raul <[Raul.Perez@sanjoseca.gov](mailto:Raul.Perez@sanjoseca.gov)>  
**Sent:** Thursday, September 24, 2020 1:56 PM  
**To:** Roland Lebrun <[REDACTED]>  
**Subject:** RE: Diridon help

Unfortunately I wouldn't have any pull in getting Google work specifically with you. Were you meaning that or with the broader community?

Raul Perez  
Councilmember, District 3  
City of San Jose

**From:** [Roland Lebrun](mailto:Roland.Lebrun)  
**Sent:** Sunday, September 20, 2020 8:46 PM  
**To:** [Perez, Raul](mailto:Perez, Raul)  
**Subject:** Diridon help

[External Email]

Raul,

Thank you for your encouraging comment at CMPP. I tried to watch the video again but most of it is missing except the last 5 minutes(?)  
<http://santaclarayta.igm7.com/Citizens/SplitView.aspx?Mode=Video&MeetingID=3170&Format=Agenda>

See below for a counterproposal to VTA's DISConnected Diridon stations (3 **so far**) but we are going to need help moving this forward.

I approached Google back in February and asked them if they would consider working on the station design collaboratively similarly to the way they invited the community to provide input on their building designs. They were open to the idea but made it very clear that the request had to come from the top; specifically, Sam reaching out to Alexa Arena's boss (I forgot his name).

Is that something you could help us with?

Thanks again.

Roland.

Purple: LRT tunnels  
White: LRT tracks  
Yellow: LRT platforms  
Green: BART station box  
Orange: Airport Connector central concourse and boarding platforms

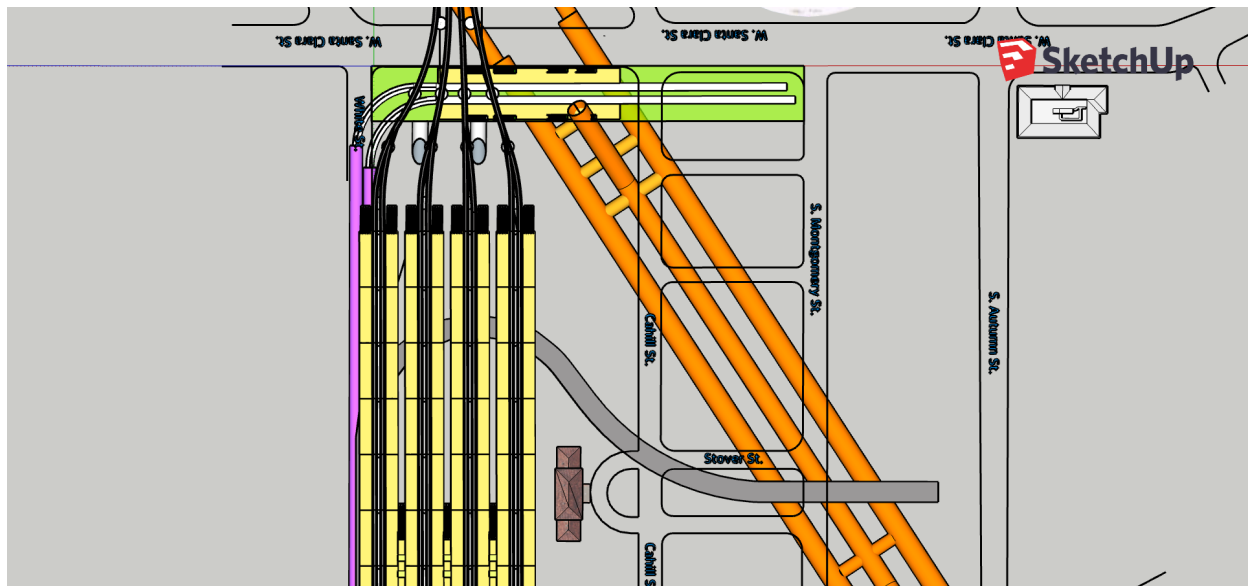

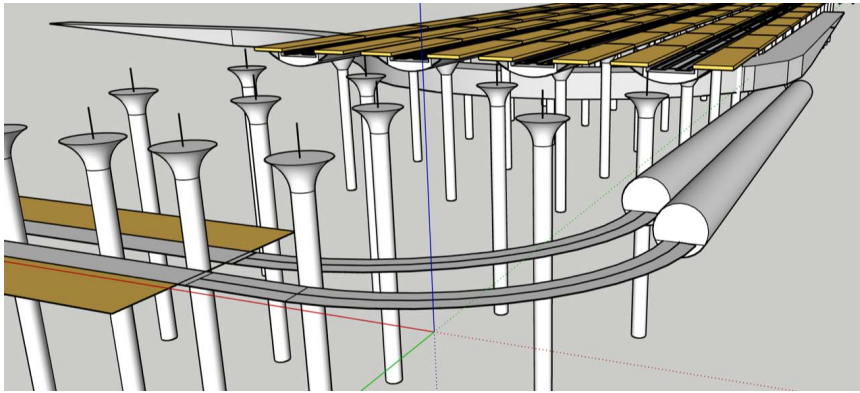

Please note how close we got to the columns: **I don't see any way how VTA's experts could possibly make a 90-degree turn in the middle of the station.** We got away with this because the columns started shifting closer together once we reached the throat at the end of the platforms. I hope this makes sense.

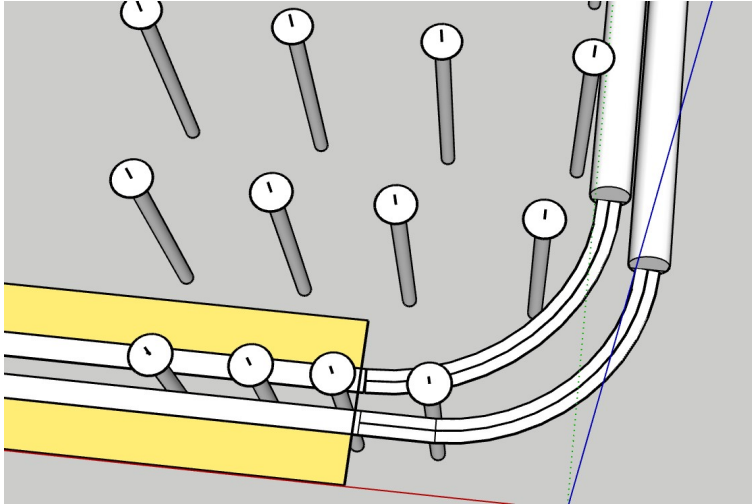

This message is from outside the City email system. Do not open links or attachments from untrusted sources.

This message is from outside the City email system. Do not open links or attachments from untrusted sources.

This message is from outside the City email system. Do not open links or attachments from untrusted sources.

This message is from outside the City email system. Do not open links or attachments from untrusted sources.