

From: [Tu, John](#)
To: [Downtown West Project](#)
Subject: Fw: Revised Encroachment Diagram
Date: Monday, March 8, 2021 10:23:20 AM
Attachments: [20210303 571900 ENCROACHMENT DIAGRAM-CONCEPTUAL UTILIDOR PLAN.pdf](#)

Best,
Tong (John) Tu

Planner IV (Supervising Planner) | Planning Division | PBCE
City of San José | 200 East Santa Clara Street
Email: john.tu@sanjoseca.gov | Phone: (408)-535-6818
For More Information Please Visit: <http://www.sanjoseca.gov/planning>

From: Amanda Wolf <amandawolf@google.com>
Sent: Saturday, March 6, 2021 9:39 AM
To: Tu, John <john.tu@sanjoseca.gov>; Tom, Vivian <Vivian.Tom@sanjoseca.gov>; Do, Ryan <ryan.do@sanjoseca.gov>; Han, James <James.Han@sanjoseca.gov>
Subject: Revised Encroachment Diagram

[External Email]

John,

Attached is a revised encroachment diagram to replace the one we submitted on 3/1.

Just two minor changes:

1. Corrected diagram to remove “properties owned by others” at West San Fernando Street and West San Carlos Street.
2. Removed “Cinnabar Street” label for clarity.

Thank you,
Amanda

--



Amanda Wolf |
Development Manager
Working for Lendlease at Google
Sunnyvale, CA |
628-240-4111

This message is from outside the City email system. Do not open links or attachments from untrusted sources.

LEGEND

- PROJECT BOUNDARY
- PRELIMINARY UTILIDOR ALIGNMENT
- UTILIDOR THOUGH PUBLIC RIGHT OF WAY
- PROPERTIES OWNED BY OTHERS

NOTES

1.

THIS DIAGRAM DEPICTS THE MAXIMUM WIDTH AND DEPTH OF AUTHORIZED ENCROACHMENTS. THE FINAL WIDTH AND DEPTH OF ANY ENCROACHMENT WILL BE DESCRIBED ON THE MAJOR ENCROACHMENT PERMIT ISSUED FOR ANY ENCROACHMENT.
2.

ISSUANCE OF ANY MAJOR ENCROACHMENT PERMIT FOR ANY ENCROACHMENT DEPICTED ON THIS DIAGRAM REQUIRES COMPLIANCE WITH THE RESOLUTION AND EXECUTION OF AN ENCROACHMENT AGREEMENT.

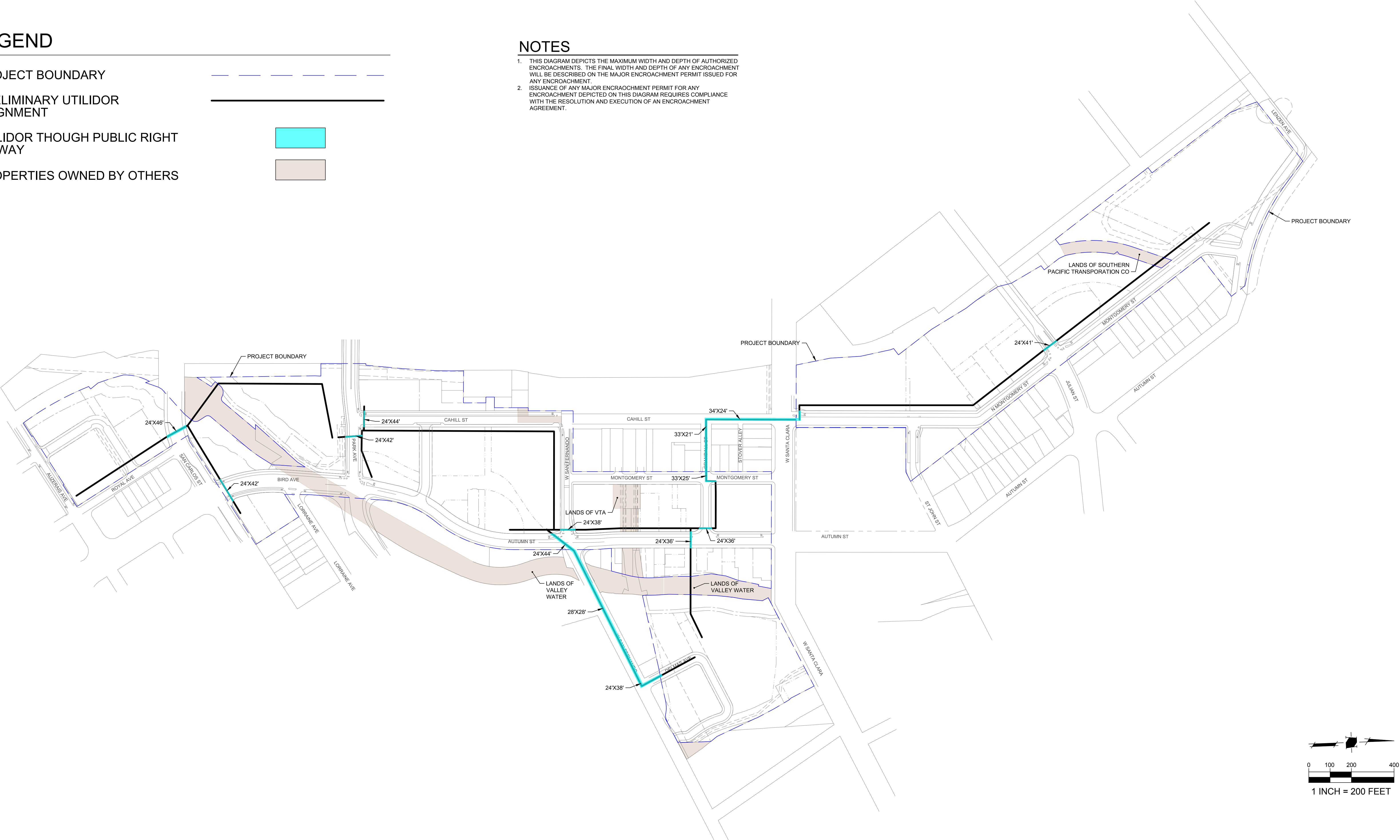

ENCROACHMENT DIAGRAM (CONCEPTUAL UTILIDOR PLAN)

Scale: 1" = 200'

Drawn: DKJ Reviewed: VNM
HMH#5719.00 | 03/01/21



1570 Oakland Road
San Jose, CA 95131
(408) 487-2200
HMHca.com