

From: [Tu, John](#)
To: [Downtown West Project](#)
Subject: Fw: Updating Google Webpage
Date: Tuesday, March 2, 2021 3:06:24 PM
Attachments: [11.5 Encroachment Diagram Conceptual Utilidor Plan.pdf](#)

Best,
Tong (John) Tu

Planner IV (Supervising Planner) | Planning Division | PBCE
City of San José | 200 East Santa Clara Street
Email: john.tu@sanjoseca.gov | Phone: (408)-535-6818
For More Information Please Visit: <http://www.sanjoseca.gov/planning>

From: Tu, John <john.tu@sanjoseca.gov>
Sent: Tuesday, March 2, 2021 2:31 PM
To: Wessling, Cheryl <Cheryl.Wessling@sanjoseca.gov>
Cc: Kuhlmann, Dylan <dylan.kuhlmann@sanjoseca.gov>; Han, James <James.Han@sanjoseca.gov>
Subject: Re: Updating Google Webpage

Dylan,

Can you upload this file and link it between Infrastructure Plan Sheet and Implementation Guide?

Best,
Tong (John) Tu

Planner IV (Supervising Planner) | Planning Division | PBCE
City of San José | 200 East Santa Clara Street
Email: john.tu@sanjoseca.gov | Phone: (408)-535-6818
For More Information Please Visit: <http://www.sanjoseca.gov/planning>

From: Tu, John <john.tu@sanjoseca.gov>
Sent: Tuesday, March 2, 2021 10:18 AM
To: Wessling, Cheryl <Cheryl.Wessling@sanjoseca.gov>
Cc: Kuhlmann, Dylan <dylan.kuhlmann@sanjoseca.gov>; Han, James <James.Han@sanjoseca.gov>
Subject: Re: Updating Google Webpage

Cheryl,

Thank you for the update. I've attached the documents. Dylan when you get a chance you can call me or we can do a zoom meeting to go over the format and location of the

documents on the website.

Best,
Tong (John) Tu

Planner IV (Supervising Planner) | Planning Division | PBCE
City of San José | 200 East Santa Clara Street
Email: john.tu@sanjoseca.gov | Phone: (408)-535-6818
For More Information Please Visit: <http://www.sanjoseca.gov/planning>

From: Wessling, Cheryl <Cheryl.Wessling@sanjoseca.gov>
Sent: Tuesday, March 2, 2021 10:14 AM
To: Tu, John <john.tu@sanjoseca.gov>
Cc: Kuhlmann, Dylan <dylan.kuhlmann@sanjoseca.gov>
Subject: Re: Updating Google Webpage

John, Dylan is in transit (driving) right now he might be back at his home computer workstation by 10:45-11:00ish. I'll have him reach out to you when he's ready to go.

Suggest you go ahead an email us the text and attachments or links to the docs so that all is in place. Dylan has become quite expert at doc uploads, so a noon deadline might still be feasible. Or by 1pm.

Cheryl Wessling, Communications Manager
City of San José | Department of Planning, Building and Code Enforcement
desk/mobile 408.535.6817 | cheryl.wessling@sanjoseca.gov
[Facebook](#) [Twitter](#) [Instagram](#) @buildingsanjose | www.sanjoseca.gov/pbce

From: Tu, John <john.tu@sanjoseca.gov>
Sent: Tuesday, March 2, 2021 9:24 AM
To: Wessling, Cheryl <Cheryl.Wessling@sanjoseca.gov>
Cc: Kuhlmann, Dylan <dylan.kuhlmann@sanjoseca.gov>
Subject: Updating Google Webpage

Cheryl or Dylan,

Do you two have time to upload and update Google webpage today? We would like to have it updated by noon if possible. We can provide the documents and text. Would 15 minute meeting at 10:30am, work for everyone?

Best,
Tong (John) Tu

Planner IV (Supervising Planner) | Planning Division | PBCE
City of San José | 200 East Santa Clara Street
Email: john.tu@sanjoseca.gov | Phone: (408)-535-6818
For More Information Please Visit: <http://www.sanjoseca.gov/planning>

LEGEND

PROJECT BOUNDARY

PRELIMINARY UTILIDOR ALIGNMENT

UTILIDOR THOUGH PUBLIC RIGHT OF WAY

PROPERTIES OWNED BY OTHERS

NOTES

1. THIS DIAGRAM DEPICTS THE MAXIMUM WIDTH AND DEPTH OF AUTHORIZED ENCROACHMENTS. THE FINAL WIDTH AND DEPTH OF ANY ENCROACHMENT WILL BE DESCRIBED ON THE MAJOR ENCROACHMENT PERMIT ISSUED FOR ANY ENCROACHMENT.
2. ISSUANCE OF ANY MAJOR ENCROACHMENT PERMIT FOR ANY ENCROACHMENT DEPICTED ON THIS DIAGRAM REQUIRES COMPLIANCE WITH THE RESOLUTION AND EXECUTION OF AN ENCROACHMENT AGREEMENT.

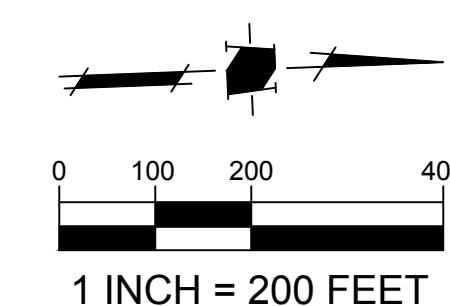
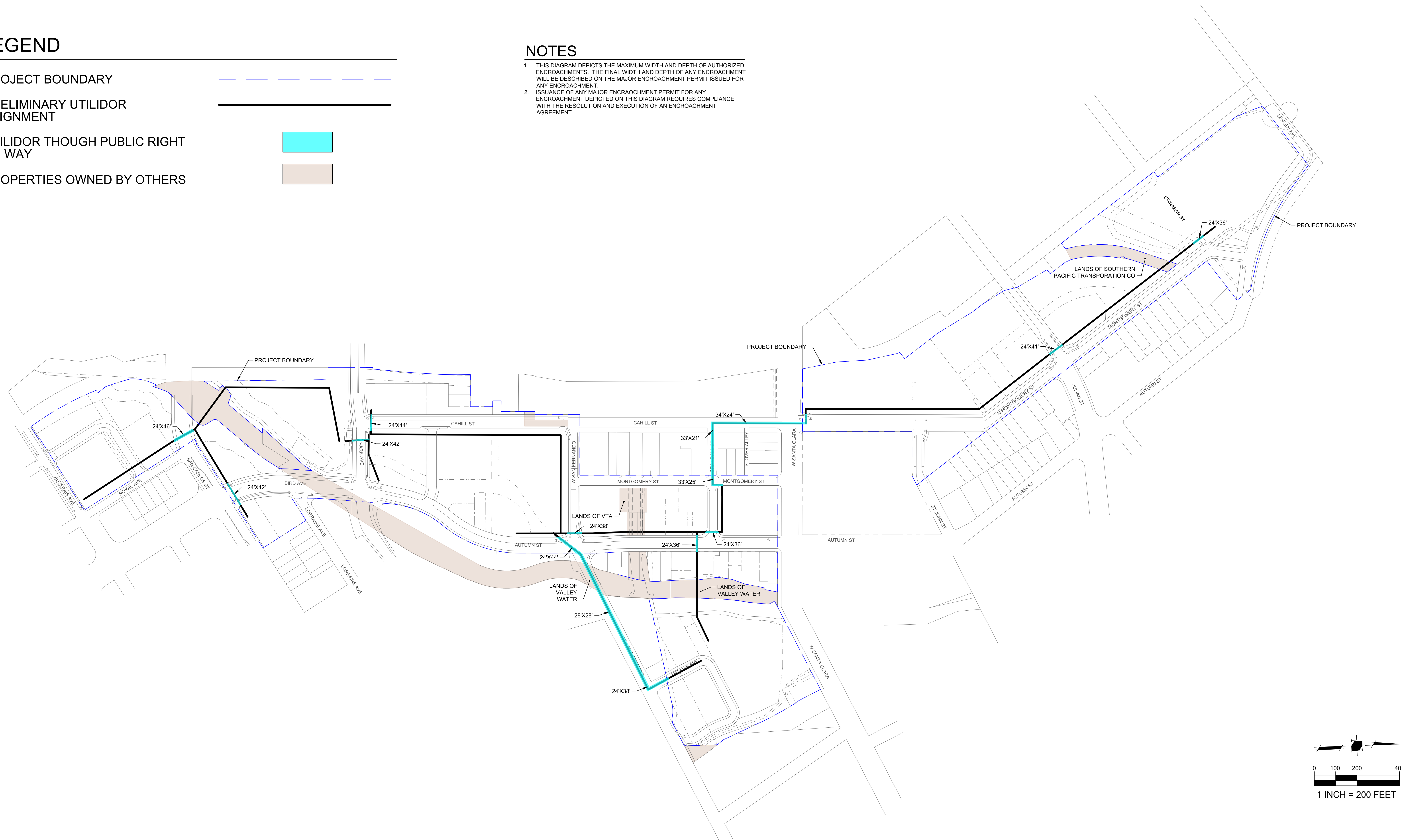

ENCROACHMENT DIAGRAM (CONCEPTUAL UTILIDOR PLAN)

Scale: 1" = 200'

Drawn: DK| Reviewed: VNM
HMH#5719.00 |03/01/21