

**SAN JOSE ARENA
(SAP CENTER)**

**525 W. SANTA CLARA STREET
SAN JOSE, CALIFORNIA**

THIRD FIVE-YEAR REVIEW

AUGUST 2018

**SAN JOSE ARENA
525 WEST SANTA CLARA STREET
SAN JOSE, CALIFORNIA
THIRD FIVE-YEAR REVIEW**

INTRODUCTION

In accordance with the Department of Toxic Substances Control's (DTSC's) requirements, the City of San Jose (CSJ) presents this Third Five-Year Review of the San Jose Arena Site (Arena), currently known as the SAP Center. The Arena is located at 525 West Santa Clara Street in San Jose, California.

The Arena is used as a venue for sporting, entertainment and other special events. During the development of the Arena and the surrounding property, soil and groundwater contamination was discovered from the previous site uses. To mitigate the contamination various remedial actions were initiated including installing a slurry wall beneath the arena to prevent groundwater contamination from migrating beneath the arena, treating petroleum contaminated soils prior for reuse on-site and screening polycyclic aromatic hydrocarbons (PAH's) to be encapsulated beneath the paved parking lot for the Arena.

The objective of this five-year review is to verify that the remedial actions implemented for this property continues to be protective of public health, safety and the environment. This review also presents groundwater data from the most recent annual groundwater monitoring event that was performed in March 2018. Groundwater is sampled and analyzed on an annual basis from the monitoring well network located on the Arena Site.

BACKGROUND

SITE LOCATION

The Arena is currently called and operated as the SAP Center (HP Pavilion). The Arena is located on approximately 22 acres with the address of 525 West Santa Clara Street in San Jose. The property is bounded to the north by Julian Street, N. Montgomery Street, and W. St. John Street, Guadalupe River to the east, W. San Carlos Street to the south, and Southern Pacific Railroad tracks to the west. The Arena footprint is surrounded by 9 acres of a paved parking lot to the north and west, and the 6-acre San Jose Arena Greens Park to the east. A map of the property is provided in Appendix A.

SITE HISTORY

The Arena is located in a historically industrial area near downtown San Jose. Among the historic site uses were a Pacific Gas & Electric (PG&E) coal gasification plant, various automotive repair and service businesses, gas stations and miscellaneous light industries. Several underground storage tanks and oil/water clarifiers were formerly located on the property.

The Arena properties history dates back to 1877 when it was a water-gas plant that used coal and crude petroleum to produce gas. In 1917 the plant was converted to an oil-gas process. The process resulted in storage of lampblack and tar-like residues. The lampblack storage was reduced in 1922 by burning residue in boilers to produce steam for plant operations. Although the plant ceased operations in 1929, the site continued to be used to store natural gas until 1951.

Beginning in the late 1980's, a total of 22 separate parcels were acquired by the City of San Jose's Redevelopment Agency (RDA) to complete the Arena Site. During development of the Arena, the existence of polycyclic aromatic hydrocarbons (PAHs) was discovered due to the former PG&E coal gasification plant operations. Concentrations up to 3,000 parts per million (ppm) of PAHs were identified in the soil. In addition, petroleum contamination including gasoline, diesel, oil and grease, benzene, toluene, ethylbenzene, and xylenes contamination was discovered in the soil and groundwater during investigation of the industrial properties.

From 1991 to 1993, groundwater sampling and reporting was done periodically. Upon completion of the Site development, monitoring ceased due to a transition period of site management from the RDA to the City of San Jose's Environmental Services Department (ESD). ESD, as self-directed, reestablished the groundwater monitoring in February 1995. Between 1995 and 2013, groundwater sampling was performed semi-annually, but beginning in 2014, sampling was performed annually due to relatively consistent results. The most recent groundwater monitoring results from the 2018 annual event is included below as part of this report.

REMEDIAL ACTIONS

REMEDY IMPLEMENTATION

The Arena construction began in 1990 and included several remedial actions to address the contamination discovered. Over 30 underground storage tanks and oil/water clarifiers at the various industrial properties were removed. A slurry wall was constructed around the 3.5-acre footprint of the Arena to prevent groundwater contamination from migrating into or out of the Arena. The area under the Arena was excavated to 17 feet bgs. The slurry (cutoff) wall was installed to a depth of 35 feet below ground surface.

All PAH impacted soil was screened for on-site reuse. Soil containing greater than 100 ppm PAH was encapsulated beneath the paved parking lot to the north and west of the Arena. Soil below 100 ppm was used as fill for either the bottom liner for the encapsulated area or as 2 feet of fill over the encapsulated area. These areas were then paved as part of the parking lot for the Arena. Approximately 20,000 cubic yards of PAH impacted soil was encapsulated.

The gasoline contaminated soil was excavated and temporarily stockpiled at the future Arena Greens park site. The soil was treated using vapor extraction. A cleanup level of 100 ppm total petroleum hydrocarbons (TPH) as gasoline was determined. Soil greater than 100 ppm after treatment was added to the encapsulated area while soil less than 100 ppm was used as fill. Approximately 100,000 cubic yards of petroleum impacted soil was treated.

After the vapor extraction treatment was completed at the Arena Greens Park site, the area was excavated to a depth of approximately 15 feet and backfilled with clean soil. The site was then developed as a park.

A Preliminary Endangerment Assessment (PEA) was completed in 1991. The Department of Health Services, predecessor to DTSC has listed the site as requiring no further action. The Regional Water Quality Control Board (RWQCB) granted case closure to the site in 1997.

DEED RESTRICTION

A Covenant to Restrict Use of Property, Environmental Restriction between the City of San Jose and DTSC was finalized for the subject site on May 23, 2003. The covenant limits site uses to commercial, industrial, parks, and/or open space use. Restricted uses include residences, hospitals, school for persons under the age of 21 and day care centers. Raising of food such as cattle and food crops is also prohibited. The DTSC is to be notified prior to any disturbances of the cap.

FIVE-YEAR REVIEW FINDINGS

SITE INSPECTION

A Site walk and inspection was conducted on April 16, 2018. Observations of general cap integrity, erosion, ponding, cracks, and/or other physical impairments were noted. The Site inspection did not show any evidence of any disturbances of the cap. No major cracks were observed in the parking areas. The San Jose Arena Green Park does not appear to have been disturbed. Appendix B shows photographs taken during the Site visit.

SITE ACTIVITIES

In 2015, the City needed to repair raised areas of asphalt and minor cracks in the parking lot due to tree roots rising toward the surface in about 28 locations. The uprising was determined to be a potential tripping hazard to the public. The cracks were minor in nature and did not expose the subsurface. The tree roots are located outside the encapsulated area of PAHs greater than 100 parts per millions. The work was performed at depths no greater than 2 feet below ground surface in the subsurface which contains asphalt, base rock and a low permeability clay blanket and did not intersect the area that contains soil with PAHs below 100 ppm. The work consisted of saw cutting the asphalt, removing the tree roots and the repaving. The DTSC was informed of the planned work and provided approval.

In early 2018, a geotechnical and environmental investigation was performed in the Arena parking lot that disturbed the cap. The purpose of the investigations are to evaluate the possibility of future buildings and parking garages on the Site. The work consisted of several cone penetration tests and soil borings up to 100 feet in depth for geotechnical evaluation and 20 geoprobe borings to depths up to 20 feet below ground surface for the environmental evaluation. A Work Plan and a Health & Safety Plan were submitted to the DTSC for review. Both Plans provided safety protections to field staff to prevent exposure risks during drilling. The borings were grouted after the samples were collected to prevent exposure to the public. The DTSC approved the Work Plan and Health & Safety Plan on February 26, 2018.

The City performed an irrigation repair project in the Arena Greens Park in early August 2018. The repair replaced a leaking irrigation line in the northwest portion of the park. The work included excavation up to 4 feet below ground surface in the "clean soil", well above the area of impacted soil. The DTSC was notified of the project and did not object to the proposed work.

ANNUAL GROUNDWATER SAMPLING AND ANALYSIS

The City has been performing annual groundwater monitoring at the San Jose Arena site since 2014. From 1995 to 2013, the City performed semi-annual monitoring. The monitoring well network consists of 13 wells screened in both the "A" and "B" water bearing zones. Samples are collected from operating and accessible wells and analyzed for: total petroleum hydrocarbons as gasoline (TPH-g), benzene, toluene, ethylbenzene and xylenes (BTEX), total petroleum hydrocarbons as diesel (TPH-d), EPA 8010 list of halogenated volatile organics, polynuclear aromatic hydrocarbons (PAHs), lead and mercury.

The results of the groundwater monitoring performed during this 5-year review period continue to indicate the groundwater contamination has remained consistent or is slightly decreasing since the early 1990s. One well, GW-1A contains petroleum contaminants and PAHs above regulatory environmental screening levels; however the results have been relatively consistent over the past 27 years. Data from well GW-1B which is located adjacent to GW-1A in the lower (deeper) "B" water bearing zone contained non-detectable levels of contaminants in the past 5 years. Other wells have contained non-detectable or low levels of petroleum contaminants and PAHs below environmental screening levels.

A copy of the most recent annual report (March 2018) is attached as Appendix C. The laboratory data and appendices are not attached.

TECHNICAL ASSESSMENT

Question A - Is the remedy functioning as intended by the decision documents?

Based upon inspections and review of data, it appears that the remedy (soil encapsulated with a engineered cap) is continuing to function as intended and continues to prevent human contact with soil and groundwater contaminated with PAHs, petroleum hydrocarbons, and other chemicals of concern. The cap also prevents rainwater infiltration into the impacted areas. Annual groundwater monitoring results show stable to slightly decreasing contamination levels indicating minimal infiltration impacts to groundwater.

Question B - Are the exposure assumptions, toxicity data, cleanup levels, and remedial action objectives (RAOs) used at the time of the remedy still valid?

At the time of the remedy, the site-specific cleanup levels established included encapsulating soil with PAHs above 100 parts per million (ppm) and Total Petroleum Hydrocarbons above 100 ppm. To accomplish that, a 2-foot cap consisting of asphalt, baserock and clean clay soil was installed under a portion of the Arena parking lot to cover the targeted contamination. A slurry wall was installed around the Arena building footprint to prevent contaminated groundwater from migrating laterally under the Arena building. Additionally, a dewatering subdrain system was installed to collect groundwater adjacent to the slurry wall to prevent it from accumulating beneath the building. The groundwater is pumped to the surface where it is run thru a treatment system prior to discharge to the storm system. The installed cap, slurry wall and treatment system are functioning as designed.

The site has remained a multi-purpose arena, primarily for sporting and entertainment events. Contaminated soil is encapsulated and there are no exposure pathways. Inspections confirm that the cap is in good condition. No newly identified contaminants or contaminant sources have been discovered during groundwater monitoring. In fact, annual groundwater monitoring has shown stable to slightly decreasing contamination levels indicating that there are minimal infiltration impacts to groundwater, and natural attenuation may be occurring.

Based upon these findings, it our opinion that the initial exposure assumptions, toxicity data, cleanup levels, and remedial action objectives used at the time of the remedy are still valid.

Question C - Has any other information come to light that could call into question the protectiveness of the cap?

During the 5-year review period there have been several projects that involved excavation into or above the cap. The projects are described in the Site Activities section on page 3 and include a project that repaired raised asphalt and minor surface cracks caused by tree roots in the parking lot, an environmental and geotechnical investigation in the parking lot and an irrigation repair project in the Arena Greens Park. The asphalt repair project in the parking lot and irrigation repair were above the capped contaminated soil. The geotechnical and environmental investigation included drilling several borings into the capped contaminated areas in the parking lot. A Soil Management Plan approved by the DTSC was in-place to manage the soil generated during drilling operation to prevent exposure risks. Upon completion of drilling, the borings were grouted with a cement mixture to seal the bore holes.

None of these projects impacted or called into question the protectiveness of the cap. No other information has been found by the City that would call into question the protectiveness of the cap.

CONCLUSIONS AND RECOMMENDATIONS

Based upon the work performed for this review, the capped area remains in good condition and continues to be protective of human health and the environment. Some minor repair of cracks in the non-PAH encapsulated area of the parking lot were repaired in 2015. The cracks were due to trees roots pushing up the asphalt surface and were minor in nature with no exposure of the subsurface to the public. The repair work was performed above the capped soil. No other evidence of significant cracks, erosion and other physical impairments of the paved parking lot or San Jose Greens Park was observed. Groundwater monitoring data appear to confirm that the implemented remedial actions are effective and functioning as intended.

Based on the Site conditions and 27 years of groundwater data, the City recommends continued annual inspections of the cap. The City will ensure the deed restrictions are followed and contact DTSC if any future disturbances of the cap are expected.

PROTECTIVENESS STATEMENTS

I certify that the remedy selected for this site remains protective of human health and the environment.

NEXT FIVE-YEAR REVIEW

The next five-year review is scheduled to be completed in May 2023. Annual inspections and annual groundwater sampling will continue to be performed in the interim, with the results sent to the DTSC.

Sincerely,



Geoff Blair
Associate Engineer
City of San Jose
Environmental Services Department

APPENDIX A

SITE MAP

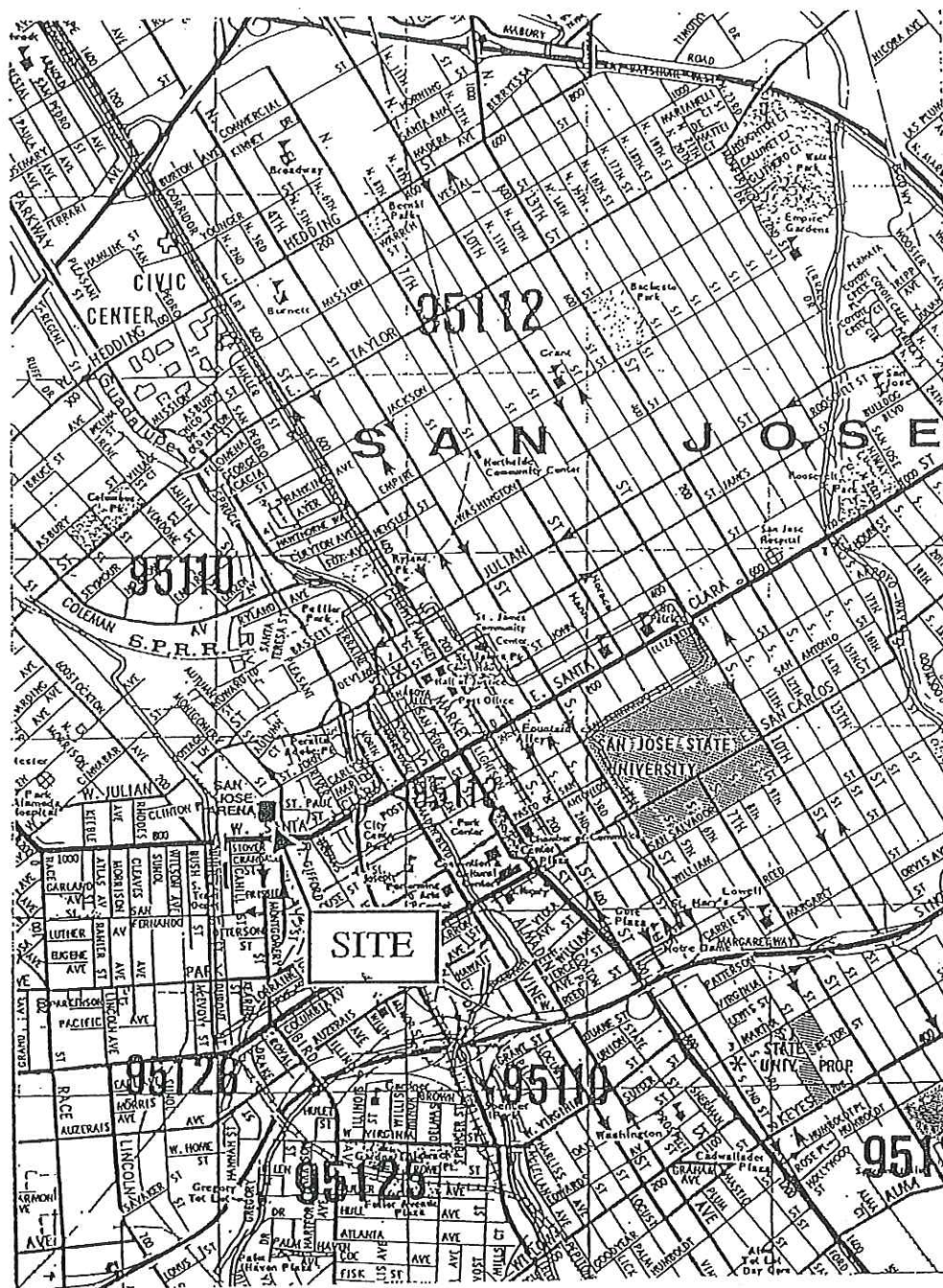

FIGURE 1

CITY OF SAN JOSE

ENVIRONMENTAL SERVICES
DEPARTMENT

SITE LOCATION MAP
SAN JOSE ARENA
GROUNDWATER MONITORING REPORT

Scale:
1" = 2500'
Date:
30-Apr-99
Drawn By:
NKF

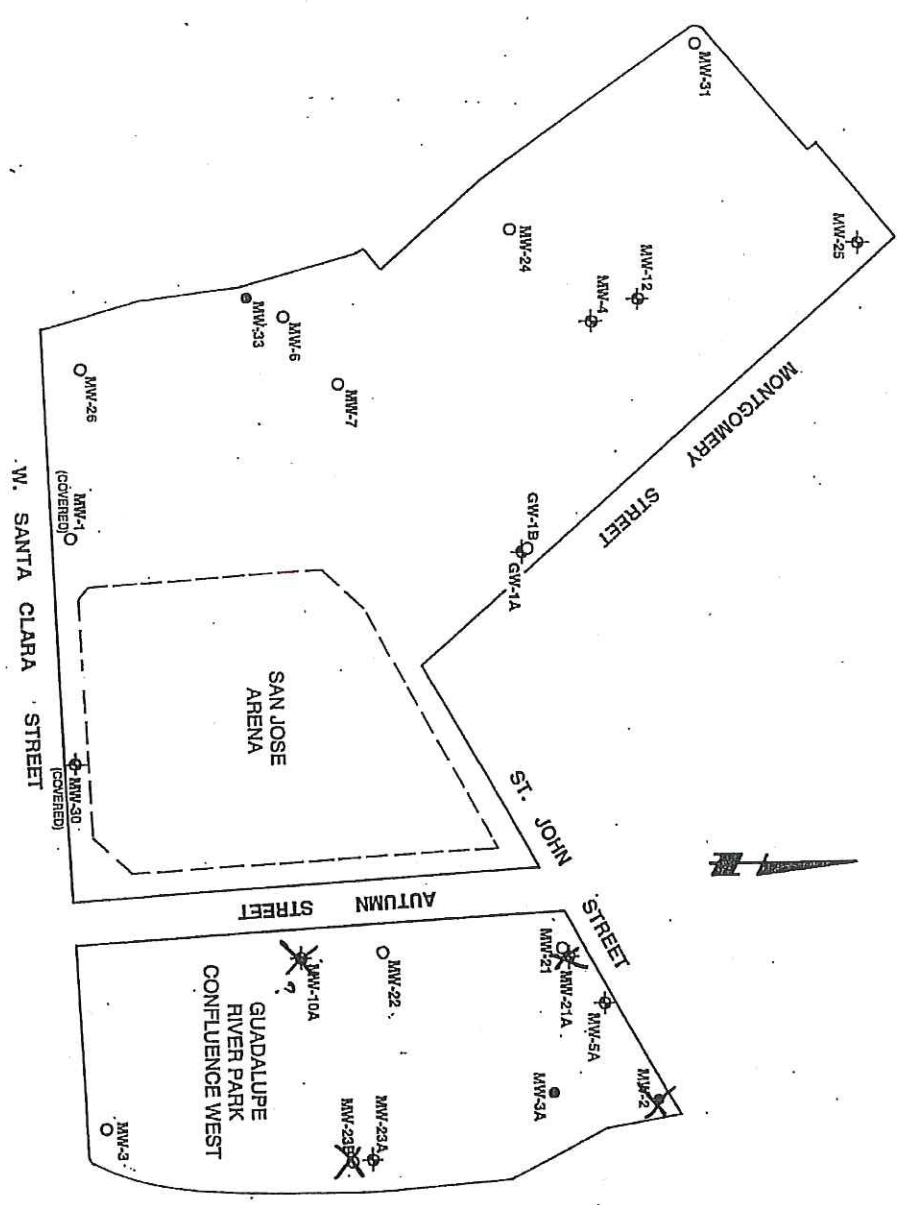

EXPLANATION

- MW-5A *A* ZONE MONITORING WELLS
- MW-22 *B* ZONE MONITORING WELLS
- MW-3A MONITORING WELLS EITHER IN AN INTERMEDIATE ZONE (MW-2), *C* ZONE (MW-39), OR NOT ACCESSIBLE (MW-3A)



Wohler Associates COVERED SEMI-ANNUAL MONITORING REPORT SAN JOSE ARENA AND GUADALUPE RIVER PARK CONFLUENCE WEST PALO ALTO • CALIFORNIA			
PROJECT NO.	DATE	FIGURE NO.	
SJC-197H/250H	SEPTEMBER 1993	2	

SITE MAP

APPENDIX B

PHOTOGRAPHIC DOCUMENTATION

SITE PHOTOGRAPHS



Photo 1: View of Arena Green near Guadalupe River



Photo 2: View of Arena Green along Autumn Street, looking north

SITE PHOTOGRAPHS



Photo 3: View of Arena Green along W. Santa Clara Street



Photo 4: View of Arena along W. Santa Clara Street, looking west

SITE PHOTOGRAPHS



Photo 5: View of Arena along W. San Carlos Street toward Arena Green, looking east



Photo 6: View of parking lot from west side near railroad tracks, looking northeasterly

SITE PHOTOGRAPHS



Photo 7: View of parking lot looking east



Photo 8: View of parking lot looking southeasterly

SITE PHOTOGRAPHS



Photo 9: View of parking lot looking northeasterly at N. Montgomery St. entrance

APPENDIX C

MARCH 2018 ANNUAL GROUNDWATER MONITORING REPORT (Without appendices)

**2018 ANNUAL GROUNDWATER
MONITORING REPORT**

**SAP CENTER
SAN JOSE ARENA**

**525 W. SANTA CLARA STREET
SAN JOSE, CALIFORNIA**

TABLE OF CONTENTS

Section

- 1.0 INTRODUCTION
- 2.0 GROUNDWATER MONITORING RESULTS
 - 2.1 Status of Monitoring Wells at the San Jose Arena
 - 2.2 Groundwater Sampling
 - 2.3 Groundwater Hydraulics
 - 2.4 Groundwater Analytical Results
 - 2.4.1 A-zone Groundwater Results
 - 2.4.2 B-zone Groundwater Results
 - 2.4.3 San Jose Arena Treatment System/Sump
- 3.0 SUMMARY OF GROUNDWATER QUALITY

Figure No.

- 1 Site Location Map
- 2 Site Map

Table No.

- 1 Groundwater Elevation Data – March 2018
- 2 Summary of 2017 Groundwater Data – March 2018
- 3 Historical Groundwater Data
 - "A" Zone Wells (1991-1993, 1995-2018)
- 4 Historical Groundwater Data
 - "B" Zone Wells (1991-1993, 1995-2018)

Appendix

- A Field Logs - Groundwater Sampling Forms
- B Laboratory Reports and Chain-of-Custody Forms

2017 ANNUAL GROUNDWATER MONITORING REPORT SAN JOSE ARENA

1.0 INTRODUCTION

The San Jose Arena (Arena) Site, currently known as the SAP Center, is a large arena primarily used for sporting and other special events. The Arena consists of approximately 22 acres located at 525 W. Santa Clara Street in downtown San Jose. Upon completion of the Arena in February 1995 the City of San Jose, as self-directed, reestablished the groundwater monitoring to track the contaminants deemed to remain beneath the Site. Between 1995 and 2012 semi-annual groundwater monitoring events were performed by the City's Environmental Services Department (ESD). Since 2012, groundwater sampling has been performed on an annual basis. This report presents the 2018 annual groundwater monitoring event results.

2.0 GROUNDWATER MONITORING RESULTS

2.1 Status of Monitoring Wells at the San Jose Arena

During this monitoring event, six of the 13 groundwater monitoring wells were found to be dry. The dry wells included MW-4, MW-7, MW-24, MW-25, MW-31 and GW-1A. In addition, two wells (MW-12 and GW-1B) had obstructions, leaving four wells that were sampled. The wells sampled were all B-zone wells and included MW-1, MW-6, MW-26 and MW-33.

2.2 Groundwater Sampling

On March 27, 2018, the 11 accessible wells containing water were measured for depth-to-water and sampled for Site-specific contaminants. RRM, Inc. of Santa Cruz performed the sampling. The groundwater beneath the Site has been defined as having an A-zone and B-zone. Monitoring wells MW-4, MW-12, MW-25, MW-30, and GW-1A are screened in the A-zone. Monitoring wells MW-1, MW-6, MW-7, MW-24, MW-26, MW-31, MW-33, and GW-1B are screened in the B-zone. The locations of the wells are shown on Figure 2 of this report.

Groundwater samples are collected with respect to the industry standard sampling protocols. Each well is purged of at least three bore volumes of groundwater. The parameters measured are temperature, odor, pH, conductivity and turbidity. Groundwater samples were collected using a submersible pump or disposable bailer, placed in appropriate sample containers, labeled, and stored in an ice-cooled container. Field data collected for each well is provided in Appendix A.

All the groundwater samples were delivered under chain-of-custody documentation to BC Labs, a State-certified laboratory for chemical analysis. Samples were analyzed for total petroleum hydrocarbons as gasoline (TPH-g) using EPA Method 8015B; total petroleum hydrocarbons as diesel (TPH-d) using EPA Method 8015B; volatile organic compounds using EPA Method 8260B; polynuclear aromatic hydrocarbons (PAHs) using EPA Method 8270C-SIM; lead by EPA Method 6010B; and mercury by EPA Method 7470B. The laboratory report and chain-of-custody documentation are included in Appendix B.

2.3 Groundwater Hydraulics

Depth-to-groundwater was measured to range between 15.11 feet (MW-1) to 20.91 feet (MW-26). Due to a majority of wells being dry or obstructed, the groundwater flow direction was not measured.

2.4 Groundwater Analytical Results

A summary of the historical groundwater data collected to date is presented in Tables 2, 3, and 4. The laboratory reports summarized in this section are provided in Appendix B.

2.4.1 A-Zone Groundwater Results

All of the A-Zone groundwater monitoring wells were either dry or obstructed.

2.4.2 B-Zone Groundwater Results

Of the four wells sampled in the B-Zone, all contained detectable levels of lead ranging from 4.1 ug/L (MW- 33) to 6.2 ug/L (MW-1). MW-1, MW-26 and MW-33 did not contain any other detectable levels of contaminants. The only other contaminant detected was 1,2-dichloroethane at 0.56 ug/L in MW-26.

2.4.3 San Jose Arena Treatment System/Sump

The Arena is situated in the shallow perched groundwater zone (referred to as the A-zone). Consequently, a dewatering system was designed into the construction of the

Arena to capture any accumulation of groundwater under and around the Arena into a centralized sump. Accumulated groundwater is treated and discharged into the municipal storm drain system. Historically, a self-directed sample was taken from influent sample port S-1 and effluent sample port S-2 and analyzed for the same constituents as those analyzed for groundwater. However, no contaminants were historically detected and therefore these samples are no longer collected and analyzed. The dewatering system remains active and operating, when groundwater is present.

3.0 SUMMARY OF GROUNDWATER QUALITY

This monitoring event was limited due to six dry wells and two wells with obstructions. The four wells sampled contained low levels of diesel and only one detectable contaminant, 1,2-dichloroethane at 0.56 ug/L in MW-26. These results are consistent or slightly lower than historic results for these four wells.

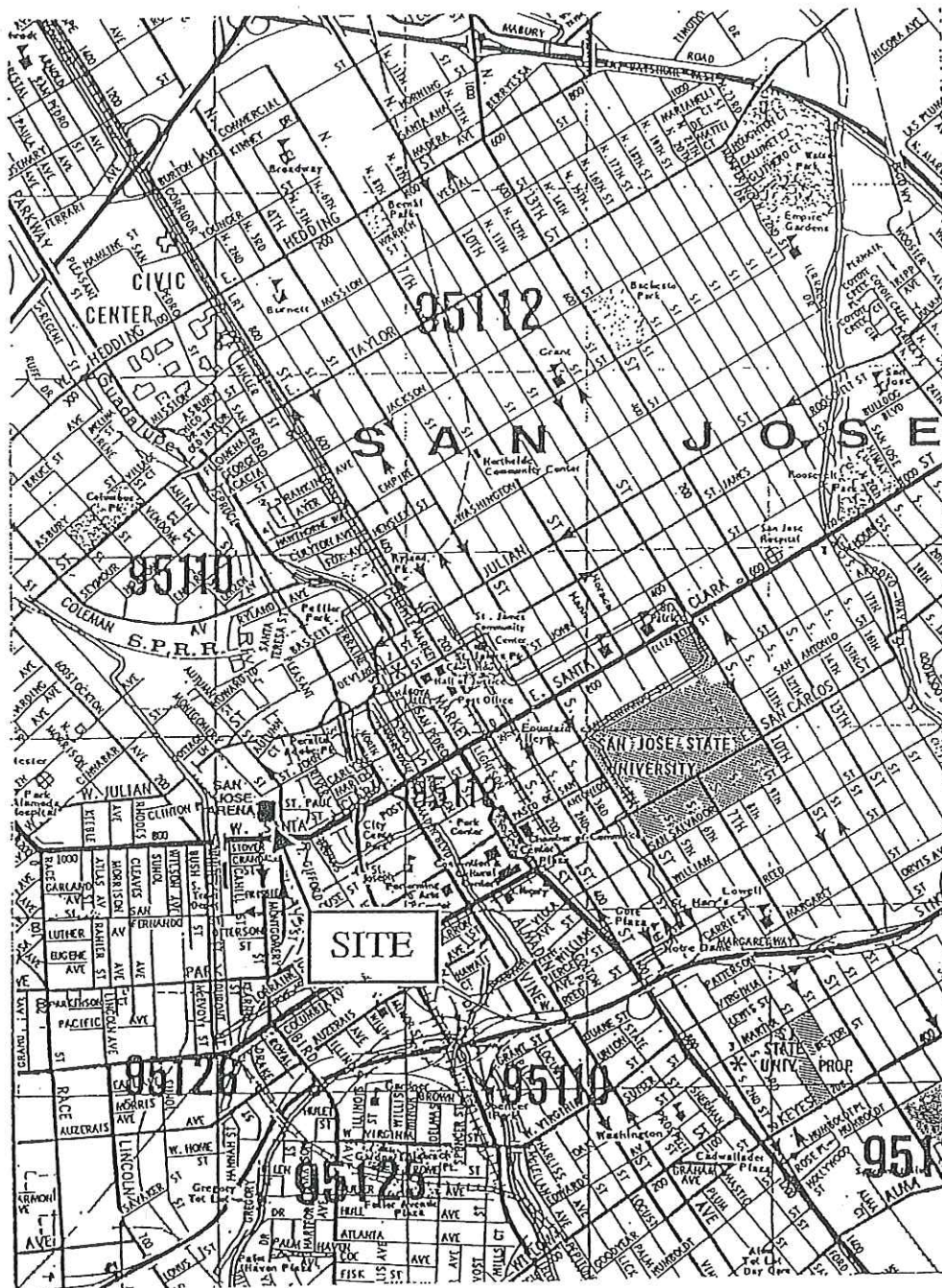
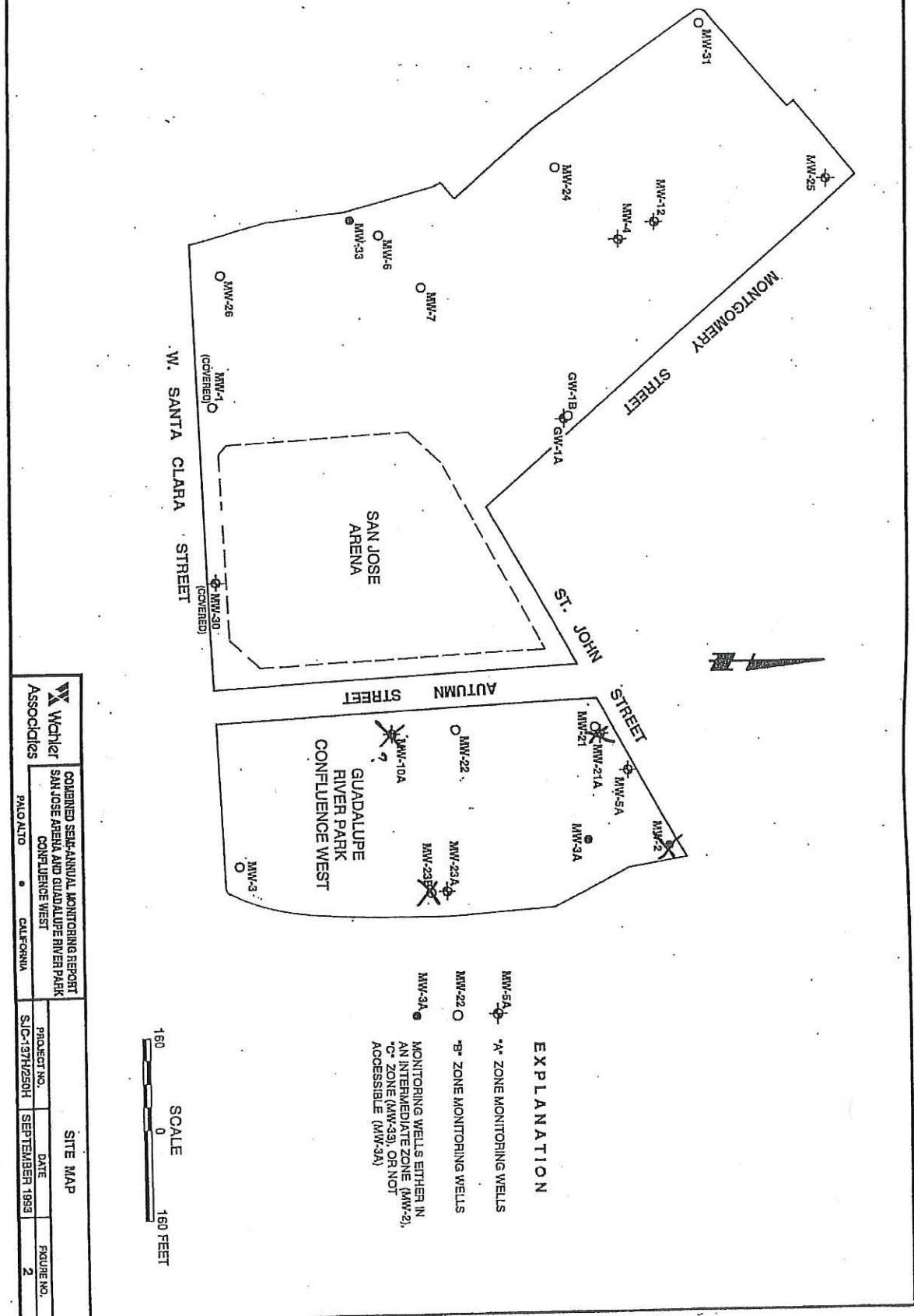

FIGURE 1

<p>CITY OF SAN JOSE</p>	<p>SITE LOCATION MAP SAN JOSE ARENA GROUNDWATER MONITORING REPORT</p>	<p>Scale: 1" = 2500'</p>
<p>ENVIRONMENTAL SERVICES DEPARTMENT</p>		<p>Date: 30-Apr-99</p>
		<p>Drawn By: NKF</p>



EXPLANATION

- MW-5A 1" ZONE MONITORING WELLS
- MW-22 18" ZONE MONITORING WELLS
- MW-3A MONITORING WELLS EITHER IN AN INTERMEDIATE ZONE (MW-2), OR NOT ACCESSIBLE (MW-3A)



Wahler Associates COMBINED SELF-ANNUAL MONITORING REPORT SAN JOSE ARENA AND GUADALUPE RIVER PARK CONFLUENCE WEST PALO ALTO • CALIFORNIA		SITE MAP PROJECT NO. _____ DATE _____ SJC-137H/250H SEPTEMBER 1993	
		FIGURE NO. 2	

TABLE 1
GROUNDWATER ELEVATION DATA
SAN JOSE ARENA
March 2018

WELL NUMBER	BOTTOM OF WELL (FT. BGS)	WATER LEVEL (FT. BGS)	WELL ELEVATIONS (FT. MSL)	GW ELEVATIONS (FT. MSL)
MW-1	58.12	15.11	85.22	70.11
MW-4	28.00	DRY	85.48	NA
MW-6	61.57	18.85	93.41	74.56
MW-7	63.51	DRY	93.39	DRY
MW-12	Obstructed			
MW-24	59.01	DRY	87.74	NA
MW-25	22.10	DRY	80.54	NA
MW-26	61.67	20.91	93.59	72.68
MW-30	12.15	Dry		
MW-31	47.61	DRY	84.96	NA
MW-33	89.01	17.21	--	--
GW-1A	41.20	DRY	85.81	NA
GW-1B	70.15	Obstructed	85.87	NA

Notes:

BGS = Below Ground Surface
MSL = Mean Sea Level

TABLE 2

SUMMARY OF 2017 GROUNDWATER DATA
SAN JOSE ARENA
March 2017

Well Number	Analytes ug/L										
	TPH-g	MTBE	Benzene	Toluene	Ethylbenzene	Total Xylenes	TPH-d	Halogenated Volatiles	Polynuclear Aromatics	Lead	Mercury
MMW-1	ND	NA	ND	ND	ND	ND	ND	ND	ND	6.2	ND
MMW-4	Well Dry ²										
MMW-6	ND	NA	ND	ND	ND	ND	ND	0.56	ND	4.9	ND
MMW-7	Well Dry ²										
MMW-12	Obstructed ¹										
MMW-24	Well Dry ²										
MMW-25	Well Dry ²										
MMW-26	ND	NA	ND	ND	ND	ND	ND	ND	ND	4.7	ND
MMW-30	Well Dry ²										
MMW-31	Well Dry ²										
MMW-33	ND	NA	ND	ND	ND	ND	ND	ND	ND	4.1	ND
GW-1A	Well Dry ²										
GW-1B	Obstructed ¹										

Notes:

- 1 Obstructed well.
 - 2 Limited groundwater available for sampling: historically dry.
- * The chromatograph does not match that of diesel standard
- TPH-g Total Petroleum Hydrocarbons as Gasoline
- TPH-d Total Petroleum Hydrocarbons as Diesel
- MTBE Methyl Tertiary Butyl Ether
- ND Not Detected
- NA Not Analyzed

TABLE 3

HISTORICAL GROUNDWATER DATA
 "A" ZONE WELLS (1991-1993, 1995-2017)
 SAN JOSE ARENA
 (concentrations in µg/L)

Well ID	TPH-g	MTBE	Benzene	Toluene	Ethylbenzene	Total Xylenes	TPH-d	VOCs	PAHs	Lead	Mercury
MW-4											
March (91)	ND(50)	NA	ND(0.5)	ND(0.5)	ND(0.5)	ND(0.5)	ND	1,2-DCA(2.0)	0.76	9.8	ND
July	ND(50)	NA	ND(0.5)	ND(0.5)	ND(0.5)	ND(0.5)	ND	1,2-DCA(1.0)	1.58	ND	ND
December	ND(50)	NA	ND(0.5)	ND(0.5)	ND(0.5)	ND(0.5)	ND	1,2-DCA(1.2)	0.366	ND	ND
March (92)	ND(30)	NA	ND(0.3)	ND(0.3)	ND(0.3)	ND(0.3)	ND	1,2-DCA(0.99)	ND	ND	ND
August	ND(50)	NA	ND(0.5)	ND(0.5)	ND(0.5)	ND(0.5)	ND	ND	ND	ND	ND
January (93)	ND(50)	NA	ND(0.5)	ND(0.5)	ND(0.5)	ND(0.5)	ND	1,2-DCA(1.2)	ND	ND	ND
June	ND(50)	NA	ND(0.5)	ND(0.5)	ND(0.5)	ND(0.5)	ND(50)	1,2-DCA(0.73)	ND	ND	ND
February (95)	ND(50)	NA	ND(0.5)	ND(0.5)	ND(0.5)	ND(0.5)	ND(100)	1,2-DCA(1.5)	ND	ND	ND
August	ND(50)	NA	ND(0.5)	ND(0.5)	ND(0.5)	ND(0.5)	190	1,2-DCA(1.1)	ND	ND	ND
March (96)	ND(50)	NA	ND(0.5)	ND(0.5)	ND(0.5)	ND(0.5)	64	1,2-DCA(1.5)	ND	ND	ND
August	ND(50)	NA	ND(0.5)	ND(0.5)	ND(0.5)	ND(0.5)	90	1,2-DCA(0.58)	2.22	0.73	0.040
March (97)	ND(50)	NA	ND(0.5)	ND(0.5)	ND(0.5)	ND(0.5)	100	1.5*	0.022	2.4	0.050
March (98)	ND(50)	ND(10)	ND(0.3)	ND(0.3)	ND(0.3)	ND(0.6)	ND(50)	1,2-DCA(0.73)	1.3	ND	ND
October	ND(50)	ND(10)	ND(0.3)	ND(0.3)	ND(0.3)	ND(0.6)	ND(50)	ND	ND	ND	ND
March (99)	ND(50)	ND(10)	ND(0.3)	ND(0.3)	ND(0.3)	ND(0.6)	110	1,1-DCA(0.79)	ND	ND	ND
September	ND(50)	ND(10)	ND(0.3)	ND(0.3)	ND(0.3)	ND(0.6)	ND(50)	ND	ND	ND	ND
March (00)	ND(50)	ND(10)	ND(0.3)	ND(0.3)	ND(0.3)	ND(0.6)	ND(50)	1,1-DCA(0.55)	ND	ND	ND
August	ND(50)	1.0	ND(0.3)	ND(0.3)	ND(0.3)	ND(0.6)	ND(50)	ND	ND	ND	ND
March (01)	ND(50)	ND(10)	ND(0.3)	ND(0.3)	ND(0.3)	ND(0.6)	ND(50)	ND	ND	ND	ND
August	ND(50)	ND(10)	ND(0.3)	ND(0.3)	ND(0.3)	ND(0.6)	ND(50)	ND	ND	ND	ND
February (02)	ND(50)	ND(10)	ND(0.3)	ND(0.3)	ND(0.3)	ND(0.6)	ND(50)	ND	ND	ND	ND
August	ND(50)	ND(2.5)	ND(0.5)	ND(0.5)	ND(0.5)	ND(0.5)	94	ND	ND	ND	ND
March (03)	ND(50)	ND(2.0)	ND(0.5)	ND(0.5)	ND(0.5)	ND(0.5)	180	ND	ND	ND (0.1)	ND (0.2)
March (04)	ND(50)	ND(2.5)	ND(0.5)	ND(0.5)	ND(0.5)	ND(0.5)	220	1,2-DCA (0.88)	ND	ND (0.1)	ND (0.2)
September	ND(50)	ND(0.5)	ND(0.5)	ND(0.5)	ND(0.5)	ND(0.5)	150	1,2-DCA (0.58)	ND	ND(100)	ND(0.2)
March (05)	ND(50)	NA	ND(0.5)	ND(0.5)	ND(0.5)	ND(0.5)				ND(100)	ND(0.2)
September	ND(50)	NA	ND(0.5)	ND(0.5)	ND(0.5)	ND(0.5)	ND(49)	ND	ND	ND(700)	ND(0.2)
April (06)	ND(50)	NA	ND(0.5)	ND(0.5)	ND(0.5)	ND(0.5)	ND(47)	ND	ND	ND(100)	ND(200)
September	ND(50)	NA	ND(0.5)	ND(0.5)	ND(0.5)	ND(0.5)	110	ND	0.82 Naph	ND(100)	ND(200)
March (07)	ND(50)	NA	ND(0.5)	ND(0.5)	ND(0.5)	ND(0.5)	ND(47)	ND	ND	ND(100)	ND(0.2)
September	ND(50)	NA	ND(0.5)	ND(0.5)	ND(0.5)	ND(0.5)	ND(49)	ND	ND	ND(100)	ND(0.2)
February (08)	ND(50)	NA	ND(0.5)	ND(0.5)	ND(0.5)	ND(0.5)	ND(48)	ND	ND	ND(100)	ND(0.2)
August (08)	ND(50)	NA	ND(0.5)	ND(0.5)	ND(0.5)	ND(0.5)	ND(49)	ND	ND	0.74	ND(0.2)
January (09)	ND(50)	NA	ND(0.5)	ND(0.5)	ND(0.5)	ND(0.5)	ND(47)	ND	ND	ND(100)	ND(0.2)
January (10)	ND(50)	NA	ND(0.5)	ND(0.5)	ND(0.5)	ND(0.5)	ND(50)	ND	ND	ND(5)	ND(0.2)
August (10)	ND(50)	NA	ND(0.5)	ND(0.5)	ND(0.5)	ND(1.5)	ND(50)	ND	ND	ND	ND
February (11)	ND(50)	NA	ND(0.5)	ND(0.5)	ND(0.5)	ND(1.5)	ND(50)	1,2-DCA (0.5)	ND	ND(5)	ND(0.2)
August (11)	ND(50)	NA	ND(0.5)	ND(0.5)	ND(0.5)	ND(1.5)	ND(50)	ND	ND	ND(5)	ND(0.2)
February (12)	ND(50)	NA	ND(0.5)	ND(0.5)	ND(0.5)	ND(1.5)	ND(50)	ND	ND	ND(5)	ND(0.2)
February (13)	ND(50)	NA	ND(0.5)	ND(0.3)	ND(0.5)	ND(1.5)	ND(50)	ND	ND	ND(5)	ND(1)
February (14)	ND(50)	NA	NA	NA	NA	NA	ND(50)	ND	ND	ND(5)	ND(1)
March (15)	ND(50)	NA	NA	NA	NA	NA	ND(250)	ND	ND	ND(50)	ND(1)
March (16)	ND(50)	NA	ND(0.3)	ND(0.3)	ND(0.5)	ND(0.5)	ND(250)	ND	ND	ND (1)	ND (0.0010)
February (17)	ND (200)	NA	ND (0.083)	ND (0.093)	ND (0.098)	ND (0.36)	ND (34)	1,2-DCA (0.36)	ND	ND(4.0)	ND (0.030)
March (18)	Well Dry - Not Sampled										

TABLE 3

HISTORICAL GROUNDWATER DATA
 "A" ZONE WELLS (1991-1993, 1995-2017)
 SAN JOSE ARENA
 (concentrations in µg/L)

Well ID	TPH-g	MTBE	Benzene	Toluene	Ethylbenzene	Total Xylenes	TPH-d	VOCs	PAHs	Lead	Mercury
Well ID	TPH-g	MTBE	Benzene	Toluene	Ethylbenzene	Total Xylenes	TPH-d	VOCs	PAHs	Lead	Mercury
March (91)	ND(50)	NA	ND(0.5)	ND(0.5)	ND(0.5)	ND(0.5)	ND	1,2-DCA(1.0)	0.73	10.1	ND
July	ND(50)	NA	ND(0.5)	ND(0.5)	ND(0.5)	ND(0.5)	ND	1,2-DCA(1.0)	ND	1.4	ND
December	ND(50)	NA	ND(0.5)	ND(0.5)	ND(0.5)	ND(0.5)	ND	1,2-DCA(0.6)	ND	ND	ND
March (92)	ND(30)	NA	ND(0.3)	ND(0.3)	ND(0.3)	ND(0.3)	ND	ND	ND	ND	ND
August	ND(50)	NA	ND(0.5)	ND(0.5)	ND(0.5)	ND(0.5)	ND	ND	ND	ND	ND
January (93)	ND(50)	NA	ND(0.5)	ND(0.5)	ND(0.5)	ND(0.5)	ND	1,2-DCA(0.64)	ND	23	ND
June	ND(50)	NA	ND(0.5)	ND(0.5)	ND(0.5)	ND(0.5)	ND(50)	ND	ND	ND	ND
February (95)	Well Damaged - Not Sampled										
August	Well Damaged - Not Sampled										
March (96)	Well Damaged - Not Sampled										
August	Well Damaged - Not Sampled										
March (97)	Well Damaged - Not Sampled										
March (98)	Well Damaged - Not Sampled										
October	Well Damaged - Not Sampled										
March (99)	Well Damaged - Not Sampled										
September	Well Damaged - Not Sampled										
March (00)	Well Damaged - Not Sampled										
August	Well Damaged - Not Sampled										
March (01)	Well Damaged - Not Sampled										
August	Well Damaged - Not Sampled										
February (02)	Well Damaged - Not Sampled										
August	Well Damaged - Not Sampled										
March (03)	Well Damaged - Not Sampled										
March (04)	Well Damaged - Not Sampled										
September	Well Damaged - Not Sampled										
March (05)	Well Damaged - Not Sampled										
September	Well Damaged - Not Sampled										
April (06)	Well Damaged - Not Sampled										
September	Well Damaged - Not Sampled										
April (07)	Well Damaged - Not Sampled										
September	Well Damaged - Not Sampled										
February (08)	Well Damaged - Not Sampled										
August (08)	Well Damaged - Not Sampled										
January (09)	Well Damaged - Not Sampled										
January (10)	Well Damaged - Not Sampled										
August (10)	Well Damaged - Not Sampled										
February (11)	Well Damaged - Not Sampled										
August (11)	Well Damaged - Not Sampled										
February (12)	Well Damaged - Not Sampled										
February (13)	Well Damaged - Not Sampled										
February (14)	Well Damaged - Not Sampled										
March (15)	Well Damaged - Not Sampled										
March (16)	Well Damaged - Not Sampled										
February (17)	Well Damaged - Not Sampled										
March (18)	Well Dry - Not Sampled										

TABLE 3

HISTORICAL GROUNDWATER DATA
 "A" ZONE WELLS (1991-1993, 1995-2017)
 SAN JOSE ARENA
 (concentrations in µg/L)

Well ID	TPH-g	MTBE	Benzene	Toluene	Ethylbenzene	Total Xylenes	TPH-d	VOCs	PAHs	Lead	Mercury
Well ID	TPH-g	MTBE	Benzene	Toluene	Ethylbenzene	Total Xylenes	TPH-d	VOCs	PAHs	Lead	Mercury
MW-25											
March (91)	ND(50)	NA	ND(0.5)	ND(0.5)	ND(0.5)	ND(0.5)	ND	ND	0.125	15.1	0.74
July	ND(50)	NA	ND(0.5)	ND(0.5)	ND(0.5)	ND(0.5)	ND	ND	ND	ND	ND
December	ND(50)	NA	ND(0.5)	ND(0.5)	ND(0.5)	ND(0.5)	ND	ND	0.222	1.1	ND
March (92)	ND(30)	NA	ND(0.3)	ND(0.3)	ND(0.3)	ND(0.3)	ND	ND	ND	ND	ND
August	ND(50)	NA	ND(0.5)	ND(0.5)	ND(0.5)	ND(0.5)	ND	ND	ND	ND	ND
January (93)	ND(50)	NA	ND(0.5)	ND(0.5)	ND(0.5)	ND(0.5)	ND	ND	ND	ND	ND
June	ND(50)	NA	ND(0.5)	ND(0.5)	ND(0.5)	ND(0.5)	ND(50)	ND	ND	ND	ND
February (95)	ND(50)	NA	ND(0.5)	ND(0.5)	ND(0.5)	ND(0.50)	ND(100)	ND	ND	7.3	ND
August	ND(50)	NA	ND(0.5)	ND(0.5)	ND(0.5)	ND(0.50)	ND(50)	ND	ND	ND	0.2
March (96)	ND(50)	NA	ND(0.5)	ND(0.5)	ND(0.5)	ND(0.50)	ND	ND	0.10	ND	ND
August	ND(50)	NA	ND(0.5)	ND(0.5)	ND(0.5)	ND(0.50)	ND	ND	ND	ND	ND
March (97)	ND(50)	NA	ND(0.5)	ND(0.5)	ND(0.5)	ND(0.50)	53	ND	ND	4.9	0.050
March (98)	ND(50)	ND(10)	ND(0.3)	ND(0.3)	ND(0.3)	ND(0.6)	ND(50)	ND	ND	ND	ND
October	ND(50)	ND(10)	ND(0.3)	ND(0.3)	ND(0.3)	ND(0.6)	130	ND	ND	ND	ND
March (99)	ND(50)	ND(10)	ND(0.3)	ND(0.3)	ND(0.3)	ND(0.6)	ND	ND	ND	ND	ND
September	ND(50)	ND(10)	ND(0.3)	ND(0.3)	ND(0.3)	ND(0.6)	ND	ND	ND	ND	ND
March (00)	ND(50)	ND(10)	ND(0.3)	ND(0.3)	ND(0.3)	ND(0.6)	ND	ND	ND	ND	ND
August	ND(50)	4.5	ND(0.3)	ND(0.3)	ND(0.3)	ND(0.6)	ND	ND	ND	ND	ND
March (01)	ND(50)	1.7	ND(0.3)	ND(0.3)	ND(0.3)	ND(0.6)	ND	ND	ND	ND	ND
August	ND(50)	ND(10)	ND(0.3)	ND(0.3)	ND(0.3)	ND(0.6)	ND	ND	ND	ND	ND
February (02)	ND(50)	ND(10)	ND(0.3)	ND(0.3)	ND(0.3)	ND(0.6)	ND	ND	ND	ND	ND
August	ND(50)	ND(2.5)	ND(0.5)	ND(0.5)	ND(0.5)	ND(0.5)	ND(50)	ND	ND	ND	ND
March (03)	ND(50)	ND(2.0)	ND(0.5)	ND(0.5)	ND(0.5)	ND(0.5)	ND(50)	ND	ND	ND (0.1)	ND (0.2)
March (04)	ND(50)	ND(2.5)	ND(0.5)	ND(0.5)	ND(0.5)	ND(0.5)	ND(50)	ND	ND	ND (0.1)	ND (0.2)
September	ND(50)	ND(0.5)	ND(0.5)	ND(0.5)	ND(0.5)	ND(0.5)	ND(47)	ND	ND	ND(100)	ND(0.2)
March (05)	ND(50)	NA	ND(0.5)	ND(0.5)	ND(0.5)	ND(0.5)	57	ND	ND	ND(100)	ND(0.2)
September	ND(50)	NA	ND(0.5)	ND(0.5)	ND(0.5)	ND(0.5)	ND(50)	ND	ND	ND(700)	ND(0.2)
April (06)	ND(50)	NA	ND(0.5)	ND(0.5)	ND(0.5)	ND(0.5)	ND(48)	ND	ND	ND(100)	ND(200)
September	ND(50)	NA	ND(0.5)	ND(0.5)	ND(0.5)	ND(0.5)	ND(48)	ND	ND	ND(100)	ND(200)
March (07)	ND(50)	NA	ND(0.5)	ND(0.5)	ND(0.5)	ND(0.5)	ND(48)	ND	3.7 Naph	ND(100)	ND(0.2)
September	ND(50)	NA	ND(0.5)	ND(0.5)	ND(0.5)	ND(0.5)	ND(49)	ND	0.54 Naph	ND(100)	ND(0.2)
February (08)	ND(50)	NA	ND(0.5)	ND(0.5)	ND(0.5)	ND(0.5)	ND(50)	ND	ND	ND(100)	ND(0.2)
August (08)	ND(50)	NA	ND(0.5)	ND(0.5)	ND(0.5)	ND(0.5)	ND(53)	ND	ND	2.3	ND(0.2)
January (09)	ND(50)	NA	ND(0.5)	ND(0.5)	ND(0.5)	ND(0.5)	ND(47)	ND	ND	ND(100)	ND(0.2)
January (10)	ND(50)	NA	ND(0.5)	ND(0.5)	ND(0.5)	ND(0.5)	ND(50)	ND	ND	ND(5)	ND(0.2)
August (10)	ND(50)	NA	ND(0.5)	ND(0.5)	ND(0.5)	ND(1.5)	ND(50)	ND	ND	ND(5)	ND(0.2)
February (11)	ND(50)	NA	ND(0.5)	ND(0.5)	ND(0.5)	ND(1.5)	ND(50)	ND	ND	ND(5)	ND(0.2)
August (11)	ND(50)	NA	ND(0.5)	ND(0.5)	ND(0.5)	ND(1.5)	ND(50)	ND	ND	ND(5)	ND(0.2)
February (12)	ND(50)	NA	ND(0.5)	ND(0.5)	ND(0.5)	ND(1.5)	ND(50)	ND	ND	ND(5)	ND(0.2)
February (13)	ND(50)	NA	ND(0.3)	ND(0.3)	ND(0.5)	ND(0.5)	ND(50)	ND	ND	ND(5)	ND(1)
February (14)	ND(50)	NA	NA	NA	NA	NA	ND(50)	ND	ND	ND(5)	ND(1)
March (15)	ND(50)	NA	NA	NA	NA	NA	ND(250)	ND	ND	ND(50)	ND(1)
March (16)	ND(50)	NA	ND(0.3)	ND(0.3)	ND(0.5)	ND(0.5)	ND(250)	ND	ND	ND (1)	ND (0.0010)
February (17)	ND (200)	NA	ND (0.083)	ND (0.093)	ND (0.098)	ND (0.36)	ND (34)	ND	ND	ND(4.0)	ND (0.030)
March (18)	Well Dry - Not Sampled										

TABLE 3

HISTORICAL GROUNDWATER DATA
 "A" ZONE WELLS (1991-1993, 1995-2017)
 SAN JOSE ARENA
 (concentrations in µg/L)

Well ID	TPH-g	MTBE	Benzene	Toluene	Ethylbenzene	Total Xylenes	TPH-d	VOCs	PAHs	Lead	Mercury
Well ID	TPH-g	MTBE	Benzene	Toluene	Ethylbenzene	Total Xylenes	TPH-d	VOCs	PAHs	Lead	Mercury
MW-30											
March (91)						Well Not Installed Yet					
July	1,800,000	NA	11,000	29,000	19,000	96,000	5,100	ND	1432	ND	ND
December	NA	NA	NA	NA	NA	NA	NA	ND	788	1.4	ND
March (92)	34,000	NA	650	800	890	2,700	52,000	ND	680	ND	ND
August	Well Dry - Not Sampled										
January (93)	Well Dry - Not Sampled										
June	Well Dry - Not Sampled										
February (95)	Well Dry - Not Sampled										
August	Well Dry - Not Sampled										
March (96)	Well Dry - Not Sampled										
August	Well Dry - Not Sampled										
March (97)	Well Dry - Not Sampled										
March (98)	Well Dry (<1ft) - Not Sampled										
October	Well Dry - Not Sampled										
March (99)	Well Dry (<1ft) - Not Sampled										
September	Well Dry (<1ft) - Not Sampled										
March (00)	Well Dry (<1ft) - Not Sampled										
August	Well Dry (<1ft) - Not Sampled										
March (01)	Well Dry (<1ft) - Not Sampled										
August	Well Dry (<1ft) - Not Sampled										
February (02)	Well Dry (<1ft) - Not Sampled										
August	Well Dry (<1ft) - Not Sampled										
March (03)	Well Dry (<1ft) - Not Sampled										
March (04)	Well Dry - Not Sampled										
September	Well Dry - Not Sampled										
March (05)	ND(50)		ND(0.5)	ND(0.5)	ND(0.5)	ND(0.5)	NA	ND	NA	NA	NA
September	Well Dry - Not Sampled										
April (06)	Well Dry - Not Sampled										
September	Well Dry - Not Sampled										
March (07)	Well Dry - Not Sampled										
September	Well Dry - Not Sampled										
February (08)	Well Dry - Not Sampled										
August (08)	Well Dry - Not Sampled										
February (08)	Well Dry - Not Sampled										
January (10)	Well Dry - Not Sampled										
August (10)	Well Dry - Not Sampled										
February (11)	Well Dry - Not Sampled										
August (11)	Well Dry - Not Sampled										
February (12)	Well Dry - Not Sampled										
February (13)	Well Dry - Not Sampled										
February (14)	Well Dry - Not Sampled										
March (15)	Well Dry - Not Sampled										
March (16)	Well Dry - Not Sampled										
Feb (17)	Well Dry - Not Sampled										
March (18)	Well Dry - Not Sampled										

TABLE 3

HISTORICAL GROUNDWATER DATA
"A" ZONE WELLS (1991-1993, 1995-2017)

SAN JOSE ARENA
(concentrations in µg/L)

Well ID	TPH-g	MTBE	Benzene	Toluene	Ethylbenzene	Total Xylenes	TPH-d	VOCs	PAHs	Lead	Mercury
Well ID	TPH-g	MTBE	Benzene	Toluene	Ethylbenzene	Total Xylenes	TPH-d	VOCs	PAHs	Lead	Mercury
GW-1A											
March (91)	ND(5000)	NA	190	ND(50)	1,900	340	11,000**	1,1-DCA(1.0)	9,693	6.2	ND
July	ND(1000)	NA	120	ND(10)	1,500	220	7,600**	ND	ND	ND	ND
December	ND(10,000)	NA	ND(100)	ND(100)	700	ND(100)	16,000**	1,1-DCA(1.3)	9,053	ND	ND
March (92)	24,000	NA	140	16	1,800	250	92,000	ND	15,000	ND	ND
August	8,800	NA	130	ND(0.5)	210	150	46,000	ND	2,000	ND	ND
January (93)	8,600	NA	110	ND(0.5)	1,100	170	66,000*	1,1-DCA(2.5)	ND	6.7	ND
June	3,000*	NA	79	4.5	560	83	16,000*	1,1-DCA(3.0)	2.06	ND	ND
February (95)	3,700	NA	49	ND	190	23	1700*	1,1-DCA(3.6)	1,464.69	2.2	ND
August	8,900	NA	170	ND	680	230	2800	1,1-DCA(95)	ND	ND	ND
March (96)	3,500	NA	76	ND	240	37	2000	1,1-DCA(6.5)	680.00	ND	ND
August	8,700	NA	150	ND	ND	ND	2300	ND	1,300.00	ND	ND
March (97)	6300	NA	130	8.1	370	80	3400	1,1-DCA(6.0)	53.6	2.6	0.020
March (98)	1600	ND(10)	140	4.9	410	74	2700	1,1-DCA(5.8)	3238.54	ND	ND
October	6500	ND(10)	120	3.9	390	55	2300	1,1-DCA(5.7)	9930**	ND	ND
March (99)	7000	ND(10)	120	3.3	390	61	1200	1,1-DCA(6.6)	5406.6**	10	ND
September	2600	ND(10)	170	3.8	370	64	6500	6.96*	1987**	ND	ND
March (00)	4600	ND(10)	140	5.3	460	61	6100	1,1-DCA(6.1)	5083**	ND	ND
August	5300	ND(10)	160	4.2	320	75	6000	1,1-DCA(6.0)	2586**	ND	ND
March (01)	4200	ND(10)	100	3.7	260	48	1500	1,1-DCA(5.6)	4370**	ND	ND
August	5200	ND(10)	120	ND	330	58	5900	1,1-DCA(5.3)	4660**	ND	ND
February (02)	4500	ND(10)	110	4.0	360	63	2600	ND	4318**	ND	ND
August	760	ND(2.5)	170	7.6	390	68	4500	ND	211.7**	17	ND
March (03)	1300	ND(2.0)	130	ND (0.5)	350	72	4200	32 Chlroform	990.1**	ND (0.1)	ND (0.2)
March (04)	2100	ND(2.5)	180	ND (0.5)	480	70	4200	ND	5336.65**	ND (0.1)	ND (0.2)
September	4500	ND(2.5)	160	5.3	410	63	5900	5.5**	2633.9**	ND(100)	ND(0.2)
March (05)	4300	NA	170	ND(10)	400	59	4700	6.1**	1317.2**	ND(100)	ND(0.2)
September	8500	NA	200	ND(12)	530	74	2400	8.1**	3948.6	ND(700)	ND(0.2)
April (06)	8400	NA	240	ND(10)	300	45	2100	1,1-DCA(3.2)	3024.6**	ND(100)	ND(200)
September	4000	NA	140	ND (10)	260	51	4100	6.2**	3760.9**	ND(100)	ND(200)
March (07)	5200	NA	170	ND (10)	340	51	3600	6.5**	5455.4**	ND(100)	ND(0.2)
September	5500	NA	190	ND (10)	390	70	3600	6.2	5670.4**	ND(100)	ND(0.2)
February (08)	5400	NA	220	5.7	490	70	11000	1,1-DCA(3.8)	9665**	ND(100)	ND(0.2)
August (08)	6000	NA	200	7.2	430	59	7200	5.7	9532.9	2.7	ND(0.2)
January (09)	7600	NA	200	ND(10)	500	53	10000	6.4	7560.6	ND(100)	ND(0.2)
January (10)	3730*	NA	202	5.94	457	32	19300	4.1	3984.27*	ND(5)	ND(0.2)
August (10)	3140*	NA	220	4.56	435	60.03	8690*	5.26	2159	ND(5)	ND(0.2)
February (11)	3180	NA	170	ND (0.5)	351	158	6080*	4.71	3114.3	ND(5)	ND(0.2)
August (11)	2950	NA	169	4.3	284	42.7	7500*	5	4161.5	ND(5)	ND(0.2)
February (12)	2520*	NA	148	4.3	180	30	6050*	5.3	1894.2	ND(5)	ND(0.2)
February (13)	9800	NA	240	ND (6)	440	20	4000	700	129	ND(5)	ND(1)
February (14)	350	NA	NA	NA	NA	NA	5100	5.5	178.2	ND(5)	ND(1)
March (15)	9900	NA	NA	NA	NA	NA	6700	ND	5726	ND(50)	ND(1)
March (16)	6200	NA	130	3.6	110	22	3300	3.3	5450	ND (1)	ND (0.0010)
Feb (17)	ND (200)	NA	170	4.6	120	15	4300	3.54	2080	5	ND (0.030)
March (18)	Well Dry - Not Sampled										

Notes:

* Chromatogram pattern is not indicative of analyte in question.

** High detection limit due to interfering hydrocarbons; unidentified

TPH-g Total Petroleum Hydrocarbons as Gasoline.

MTBE Methyl Tertiary Butyl Ether

TPH-d Total Petroleum Hydrocarbons as Diesel.

EPA-8010 Halogenated Volatile Organic Chemicals.

EPA-8310 Polynuclear Aromatics

ND(##) Not Detected at detection limits in parentheses (parts per billion - ppb)

ND Not Detected

NA Not Analyzed

TABLE 4

HISTORICAL GROUNDWATER DATA
 "B" ZONE WELLS (1991-1993, 1995-2017)
 SAN JOSE ARENA
 (concentrations in µg/L)

Well ID	TPH-g	MTBE	Benzene	Toluene	Ethylbenzene	Total Xylenes	TPH-d	VOCs	PAHs	Lead	Mercury
MW-1											
March (91)	ND(50)	NS	ND(0.5)	ND(0.5)	ND(0.5)	ND(0.5)	ND	ND	0.29	34.2	0.42
July	ND(50)	NS	ND(0.5)	ND(0.5)	ND(0.5)	ND(0.5)	ND	ND	ND	ND(1.0)	ND(0.2)
December	ND(50)	NS	ND(0.5)	ND(0.5)	ND(0.5)	ND(0.5)	ND	ND	ND	ND(1.0)	ND(0.2)
March (92)	Well Could Not Be Sampled										
August	Well Could Not Be Sampled										
January (93)	Well Could Not Be Sampled										
June	Well Could Not Be Sampled										
February (95)	ND(50)	NS	ND(0.5)	ND(0.5)	ND(0.5)	ND(0.50)	ND(100)	ND	ND	1.8	ND(0.2)
August	Well Damaged - Not Sampled										
March (96)	Well Damaged - Not Sampled										
August	Well Damaged - Not Sampled										
March (97)	Well Damaged - Not Sampled										
March (98)	Well Damaged - Not Sampled										
October	Well Damaged - Not Sampled										
March (99)	Well Damaged - Not Sampled										
September	Well Damaged - Not Sampled										
March (00)	Well Damaged - Not Sampled										
August	Well Damaged - Not Sampled										
March (01)	Well Damaged - Not Sampled										
August	Well Damaged - Not Sampled										
February (02)	Well Damaged - Not Sampled										
August	Well Damaged - Not Sampled										
March (03)	Well Damaged - Not Sampled										
March (04)	ND(50)	ND(2.5)	ND(0.5)	ND(0.5)	ND(0.5)	ND(0.5)	260	ND	ND	ND(0.1)	0.67
September	ND(50)	ND(0.5)	ND(0.5)	ND(0.5)	ND(0.5)	ND(0.5)	ND(47)	ND	ND	ND(100)	ND(0.2)
March (05)	ND(50)	NA	ND(0.5)	ND(0.5)	ND(0.5)	ND(0.5)	90	ND	ND	ND(100)	ND(0.2)
September	ND(50)	NA	ND(0.5)	ND(0.5)	ND(0.5)	ND(0.5)	ND(50)	ND	ND	ND(700)	ND(0.2)
April (06)	ND(50)	NA	ND(0.5)	ND(0.5)	ND(0.5)	ND(0.5)	ND(47)	ND	ND	ND(100)	ND(200)
September	ND(50)	NA	ND(0.5)	ND(0.5)	ND(0.5)	ND(0.5)	ND(53)	ND	0.96	ND(100)	ND(200)
March (07)	ND(50)	NA	ND(0.5)	ND(0.5)	ND(0.5)	ND(0.5)	ND(48)	ND	ND	ND(100)	ND(0.2)
September	ND(50)	NA	ND(0.5)	ND(0.5)	ND(0.5)	ND(0.5)	ND(49)	ND	ND	ND(100)	ND(0.2)
February (08)	ND(50)	NA	ND(0.5)	ND(0.5)	ND(0.5)	ND(0.5)	ND(50)	7.01	ND	ND(100)	ND(0.2)
August (08)	ND(50)	NA	ND(0.5)	ND(0.5)	ND(0.5)	ND(0.5)	ND(50)	ND	ND	4.7	ND(0.2)
January (09)	ND(50)	NA	ND(0.5)	ND(0.5)	ND(0.5)	ND(0.5)	ND(47)	ND	ND	ND(100)	ND(0.2)
January (10)	ND(50)	NA	ND(0.5)	ND(0.5)	ND(0.5)	ND(0.5)	ND(50)	ND	ND	ND(5)	ND(0.2)
August (10)	ND(50)	NA	ND(0.5)	ND(0.5)	ND(0.5)	ND(1.5)	ND(50)	ND	ND	ND(5)	ND(0.2)
February (11)	ND(50)	NA	ND(0.5)	ND(0.5)	ND(0.5)	ND(1.5)	ND(50)	ND	ND	ND(5)	ND(0.2)
August (11)	ND(50)	NA	ND(0.5)	ND(0.5)	ND(0.5)	ND(1.5)	ND(50)	ND	ND	ND(5)	ND(0.2)
February (12)	ND(50)	NA	ND(0.5)	ND(0.5)	ND(0.5)	ND(1.5)	ND(50)	ND	ND	18.5	0.313
February (13)	ND(50)	NA	ND(0.3)	ND(0.3)	ND(0.5)	ND(0.5)	ND(50)	ND	ND	ND(5)	ND(1)
February (14)	ND(50)	NA	NA	NA	NA	NA	ND(50)	ND	ND	ND(5)	ND(1)
March (15)	ND(50)	NA	NA	NA	NA	NA	ND(250)	ND	ND	ND(50)	ND(1)
March (16)	ND(50)	NA	ND (0.3)	ND (0.3)	ND(0.5)	ND(0.5)	ND(250)	ND	ND	ND (1)	ND (0.001)
February (17)	ND (200)	NA	ND (0.083)	ND (0.093)	ND (0.098)	ND (0.36)	ND (34)	ND	0.052	ND (4.0)	ND (0.030)
March (18)	ND(50)	NA	ND(0.5)	ND(0.5)	ND(0.5)	ND(1.0)	ND(50)	ND	ND	6.2	ND(0.2)

TABLE 4

HISTORICAL GROUNDWATER DATA
 "B" ZONE WELLS (1991-1993, 1995-2017)
 SAN JOSE ARENA
 (concentrations in µg/L)

Well ID	TPH-g	MTBE	Benzene	Toluene	Ethylbenzene	Total Xylenes	TPH-d	VOCs	PAHs	Lead	Mercury
Well ID	TPH-g	MTBE	Benzene	Toluene	Ethylbenzene	Total Xylenes	TPH-d	VOCs	PAHs	Lead	Mercury
MW-6											
March (91)	Well Could Not Be Sampled										
July	Well Could Not Be Sampled										
December	Well Could Not Be Sampled										
March (92)	Well Could Not Be Sampled										
August	Well Could Not Be Sampled										
January (93)	Well Could Not Be Sampled										
June	Well Could Not Be Sampled										
February (95)	Well Damaged - Not Sampled										
August	Well Damaged - Not Sampled										
March (96)	Well Damaged - Not Sampled										
August	Well Damaged - Not Sampled										
March (97)	Well Damaged - Not Sampled										
March (98)	Well Damaged - Not Sampled										
October	Well Damaged - Not Sampled										
March (99)	Well Damaged - Not Sampled										
September	Well Damaged - Not Sampled										
March (00)	Well Damaged - Not Sampled										
August	Well Damaged - Not Sampled										
March (01)	Well Damaged - Not Sampled										
August	Well Damaged - Not Sampled										
February (02)	Well Damaged - Not Sampled										
August	Well Damaged - Not Sampled										
March (03)	Well Damaged - Not Sampled										
March (04)	ND(50)	ND(2.5)	ND(0.5)	ND(0.5)	ND(0.5)	ND(0.50)	ND(50)	ND	ND	ND(0.1)	ND(0.2)
September	NS	NA	NS	NS	NS	NS	NS	NS	NS	NS	NS
March (05)	ND(50)	NA	ND(0.5)	ND(0.5)	ND(0.5)	ND(0.50)	150	ND	ND	ND(100)	ND(0.2)
September	ND(50)	NA	ND(0.5)	ND(0.5)	ND(0.5)	ND(0.50)	71	ND	3.3 Naph	ND(700)	ND(0.2)
April (06)	ND(50)	NA	ND(0.5)	ND(0.5)	ND(0.5)	ND(0.50)	ND(47)	ND	ND	ND(100)	ND(200)
September	ND(50)	NA	ND(0.5)	ND(0.5)	ND(0.5)	ND(0.50)	320	ND	1.2 Naph	ND(100)	ND(200)
March (07)	ND(50)	NA	ND(0.5)	ND(0.5)	ND(0.5)	ND(0.50)	ND(48)	ND	ND	ND(100)	ND(200)
September	Well Damaged - Not Sampled										
February (08)	Well Damaged - Not Sampled										
January (09)	Well Damaged - Not Sampled										
January (10)	Well Damaged - Not Sampled										
August (10)	Well Damaged - Not Sampled										
February (11)	Well Damaged - Not Sampled										
August (11)	Well Damaged - Not Sampled										
February (12)	ND(50)	NA	ND(0.5)	ND(0.5)	ND(0.5)	ND(1.5)	ND(50)	ND	ND	ND (5)	ND (0.2)
February (13)	ND(50)	NA	ND(0.3)	ND(0.3)	ND(0.5)	ND(0.5)	82	ND	ND	ND (5)	ND (1)
February (14)	ND(50)	NA	NA	NA	NA	NA	630	ND	ND	ND (5)	ND (1)
March (15)	ND(50)	NA	NA	NA	NA	NA	ND(2500)	ND	ND	ND (50)	ND (1)
March (16)	Well Damaged - Not Sampled										
February (17)	ND (200)	NA	ND (0.083)	ND (0.093)	ND (0.098)	ND (0.36)	ND (34)	0.33 1,2-DCA	0.34	ND (4.0)	ND (0.030)
March (18)	ND (50)	NA	ND (0.5)	ND (0.5)	ND (0.5)	ND (1.0)	ND (50)	0.56 1,2-DCA	ND	4.9	ND (0.20)

TABLE 4

HISTORICAL GROUNDWATER DATA
 "B" ZONE WELLS (1991-1993, 1995-2017)
 SAN JOSE ARENA
 (concentrations in µg/L)

Well ID	TPH-g	MTBE	Benzene	Toluene	Ethylbenzene	Total Xylenes	TPH-d	VOCs	PAHs	Lead	Mercury
Well ID	TPH-g	MTBE	Benzene	Toluene	Ethylbenzene	Total Xylenes	TPH-d	VOCs	PAHs	Lead	Mercury
MW-7											
March (91)	ND(50)	NA	ND(0.5)	ND(0.5)	ND(0.5)	ND(0.5)	ND	ND	1.08	21.4	ND
July	ND(50)	NA	ND(0.5)	ND(0.5)	ND(0.5)	ND(0.5)	ND	ND	0.114	ND	ND
December	ND(50)	NA	ND(0.5)	ND(0.5)	ND(0.5)	ND(0.5)	ND	ND	0.132	ND	ND
March (92)	ND(30)	NA	ND(0.3)	ND(0.3)	ND(0.3)	ND(0.3)	ND	ND	ND	ND	ND
August	Well Could Not Be Sampled										
January (93)	Well Could Not Be Sampled										
June	Well Could Not Be Sampled										
February (95)	ND(50)	NA	ND(0.5)	ND(0.5)	ND(0.5)	ND(0.50)	ND(100)	ND	ND	ND	ND
August	ND	NA	0.98	ND	ND	ND	110	ND	ND	ND	ND
March (96)	ND(50)	NA	ND(0.5)	ND(0.5)	ND(0.5)	ND(0.50)	200	ND	ND	ND	ND
August	ND(50)	NA	3.2	ND(0.5)	1.8	2.3	240	ND	ND	1.4	ND
March (97)	ND(50)	NA	ND(0.5)	ND(0.5)	ND(0.5)	ND(0.50)	ND(100)	ND	ND	1.4	0.68
March (98)	ND(50)	ND(10)	ND(0.3)	ND(0.3)	ND(0.3)	ND(0.6)	ND(50)	ND	ND	ND (0.1)	ND (0.2)
October	ND(50)	ND(10)	ND(0.3)	ND(0.3)	ND(0.3)	ND(0.6)	ND(50)	ND	ND	ND (0.1)	ND (0.2)
March (99)	ND(50)	ND(10)	ND(0.3)	ND(0.3)	ND(0.3)	ND(0.6)	ND(50)	ND	ND	ND (0.1)	ND (0.2)
September	ND(50)	ND(10)	1.7	ND(0.3)	ND(0.3)	ND(0.6)	ND(50)	ND	ND	ND (0.1)	ND (0.2)
March (00)	ND(50)	ND(10)	ND(0.3)	ND(0.3)	ND(0.3)	ND(0.6)	ND(50)	ND	ND	ND (0.1)	ND (0.2)
August	ND(50)	2.1	ND(0.3)	ND(0.3)	ND(0.3)	ND(0.6)	ND(50)	ND	ND	ND (0.1)	ND (0.2)
March (01)	ND(50)	ND(10)	ND(0.3)	ND(0.3)	ND(0.3)	ND(0.6)	ND(50)	ND	ND	ND (0.1)	ND (0.2)
August	ND(50)	ND(10)	ND(0.3)	ND(0.3)	ND(0.3)	ND(0.6)	ND(50)	ND	ND	ND (0.1)	ND (0.2)
February (02)	ND(50)	ND(10)	ND(0.3)	ND(0.3)	ND(0.3)	ND(0.6)	ND(50)	ND	ND	ND (0.1)	ND (0.2)
August	ND(50)	ND(2.5)	ND(0.5)	ND(0.5)	ND(0.5)	ND(0.5)	ND(50)	ND	ND	ND (0.1)	ND (0.2)
March (03)	ND(50)	ND(2.0)	ND(0.5)	ND(0.5)	ND(0.5)	ND(0.5)	79	0.51 Chloroform	ND	ND (0.1)	ND (0.2)
March (04)	ND(50)	ND(2.50)	ND(0.5)	ND(0.5)	ND(0.5)	ND(0.5)	120	ND	ND	ND (0.1)	ND (0.2)
September	ND(50)	ND(0.5)	ND(0.5)	ND(0.5)	ND(0.5)	ND(0.5)	ND(48)	ND	ND	ND(100)	ND(0.2)
March (05)	ND(50)	NA	ND(0.5)	ND(0.5)	ND(0.5)	ND(0.5)	140	ND	ND	ND(100)	ND(0.2)
September	ND(50)	NA	ND(0.5)	ND(0.5)	ND(0.5)	ND(0.5)	ND(48)	ND	ND	ND(700)	ND(0.2)
April (06)	ND(50)	NA	ND(0.5)	ND(0.5)	ND(0.5)	ND(0.5)	ND(48)	ND	ND	ND(100)	ND(200)
September	ND(50)	NA	ND(0.5)	ND(0.5)	ND(0.5)	ND(0.5)	ND(48)	ND	ND	ND(100)	ND(200)
March (07)	ND(50)	NA	ND(0.5)	ND(0.5)	ND(0.5)	ND(0.5)	ND(48)	ND	0.55 Napth.	ND(100)	ND(0.2)
September	ND(50)	NA	ND(0.5)	ND(0.5)	ND(0.5)	ND(0.5)	ND(49)	ND	ND	ND(100)	ND(0.2)
February (08)	ND(50)	NA	ND(0.5)	ND(0.5)	ND(0.5)	ND(0.5)	ND(51)	ND	ND	ND(100)	ND(0.2)
August (08)	ND(50)	NA	ND(0.5)	ND(0.5)	ND(0.5)	ND(0.5)	ND(50)	ND	ND	ND(0.5)	ND(0.2)
January (09)	ND(50)	NA	ND(0.5)	ND(0.5)	ND(0.5)	ND(0.5)	ND(47)	ND	ND	ND(100)	ND(0.2)
January (10)	ND(50)	NA	ND(0.5)	ND(0.5)	ND(0.5)	ND(0.5)	ND(50)	ND	ND	ND(5)	ND(0.2)
August (10)	ND(50)	NA	ND(0.5)	ND(0.5)	ND(0.5)	ND(1.5)	ND(50)	ND	ND	ND(5)	ND(0.2)
February (11)	ND(50)	NA	ND(0.5)	ND(0.5)	ND(0.5)	ND(1.5)	ND(50)	ND	ND	ND(5)	ND(0.2)
August (11)	ND(50)	NA	ND(0.5)	ND(0.5)	ND(0.5)	ND(1.5)	ND(50)	ND	ND	ND(5)	ND(0.2)
February (12)	ND(50)	NA	ND(0.5)	ND(0.5)	ND(0.5)	ND(1.5)	ND(50)	ND	ND	ND (5)	ND (0.2)
February (13)	ND(50)	NA	ND(0.3)	ND(0.3)	ND(0.5)	ND(0.5)	ND(50)	ND	ND	ND (5)	ND (1)
February (14)	ND(50)	NA	NA	NA	NA	NA	ND(50)	ND	ND	ND (5)	ND (1)
March (15)	ND(50)	NA	NA	NA	NA	NA	ND(50)	ND	ND	ND (50)	ND (1)
March (16)	ND(50)	NA	ND (0.3)	ND (0.3)	ND(0.5)	ND(0.5)	ND(250)	ND	ND	ND (1)	ND (0.001)
February (17)	ND (200)	NA	ND (0.083)	ND (0.093)	ND (0.098)	ND (0.36)	ND (34)	0.34	ND	ND (4.0)	ND (0.030)
March (18)	Well Dry										

TABLE 4

HISTORICAL GROUNDWATER DATA
 "B" ZONE WELLS (1991-1993, 1995-2017)
 SAN JOSE ARENA
 (concentrations in µg/L)

Well ID	TPH-g	MTBE	Benzene	Toluene	Ethylbenzene	Total Xylenes	TPH-d	VOCs	PAHs	Lead	Mercury
Well ID	TPH-g	MTBE	Benzene	Toluene	Ethylbenzene	Total Xylenes	TPH-d	VOCs	PAHs	Lead	Mercury
MW-24											
March (91)	ND(50)	NA	ND(0.5)	ND(0.5)	ND(0.5)	ND(0.5)	ND	ND	ND	2.2	ND
July	ND(50)	NA	ND(0.5)	ND(0.5)	ND(0.5)	ND(0.5)	ND	ND	ND	ND	ND
December	ND(50)	NA	ND(0.5)	0.5	ND(0.5)	0.84	ND	ND	ND	1.5	ND
March (92)	ND(30)	NA	ND(0.3)	ND(0.3)	ND(0.3)	ND(0.3)	ND	ND	ND	ND	ND
August	ND(50)	NA	ND(0.5)	ND(0.5)	ND(0.5)	ND(0.5)	ND	ND	ND	ND	ND
January (93)	ND(50)	NA	ND(0.5)	ND(0.5)	ND(0.5)	ND(0.5)	ND	ND	ND	ND	ND
June	ND(50)	NA	ND(0.5)	ND(0.5)	ND(0.5)	ND(0.5)	150**	ND	ND	ND	ND
February (95)	ND(50)	NA	ND(0.5)	ND(0.5)	ND(0.5)	ND(0.5)	ND(50)	ND	ND	ND	ND
August	ND(50)	NA	ND(0.5)	ND(0.5)	ND(0.5)	ND(0.5)	ND(50)	ND	ND	ND	ND
March (96)	ND(50)	NA	ND(0.5)	ND(0.5)	ND(0.5)	ND(0.5)	ND(50)	ND	0.68	ND	ND
August	ND(50)	NA	ND(0.5)	ND(0.5)	ND(0.5)	ND(0.5)	ND(50)	ND	ND	1.2	ND
March (97)	ND(50)	NA	ND(0.5)	ND(0.5)	ND(0.5)	ND(0.5)	ND(50)	ND	ND	2.1	0.71
March (98)	ND(50)	ND(10)	ND(0.3)	ND(0.3)	ND(0.3)	ND(0.6)	ND(50)	ND	ND	ND(0.1)	ND(0.2)
October	ND(50)	ND(10)	ND(0.3)	ND(0.3)	ND(0.3)	ND(0.6)	ND(50)	ND	ND	ND(0.1)	ND(0.2)
March (99)	ND(50)	ND(10)	ND(0.3)	ND(0.3)	ND(0.3)	ND(0.6)	ND(50)	ND	ND	ND(0.1)	ND(0.2)
September	ND(50)	ND(10)	ND(0.3)	ND(0.3)	ND(0.3)	ND(0.6)	ND(50)	ND	ND	ND(0.1)	ND(0.2)
March (00)	ND(50)	ND(10)	ND(0.3)	ND(0.3)	ND(0.3)	ND(0.6)	ND(50)	ND	ND	ND(0.1)	ND(0.2)
August	ND(50)	2.3	ND(0.3)	ND(0.3)	ND(0.3)	ND(0.6)	ND(50)	ND	ND	ND(0.1)	ND(0.2)
March (01)	ND(50)	ND(10)	ND(0.3)	ND(0.3)	ND(0.3)	ND(0.6)	ND(50)	ND	ND	ND(0.1)	ND(0.2)
August	ND(50)	ND(10)	ND(0.3)	ND(0.3)	ND(0.3)	ND(0.6)	ND(50)	ND	ND	ND(0.1)	ND(0.2)
February (02)	ND(50)	ND(10)	ND(0.3)	ND(0.3)	ND(0.3)	ND(0.6)	ND(50)	ND	ND	ND(0.1)	ND(0.2)
August	ND(50)	ND(2.5)	ND(0.5)	ND(0.5)	ND(0.5)	ND(0.5)	740	ND	ND	ND(0.1)	ND(0.2)
March (03)	ND(50)	ND(2.0)	ND(0.5)	ND(0.5)	ND(0.5)	ND(0.5)	75	ND	ND	ND(0.1)	ND(0.2)
March (04)	ND(50)	ND(2.5)	ND(0.5)	ND(0.5)	ND(0.5)	ND(0.5)	76	ND	ND	ND(0.1)	ND(0.2)
September	ND(50)	ND(0.5)	ND(0.5)	ND(0.5)	ND(0.5)	ND(0.5)	ND(48)	ND	ND	ND(100)	ND(0.2)
March (05)	ND(50)	NA	ND(0.5)	ND(0.5)	ND(0.5)	ND(0.5)	160	ND	ND	ND(100)	ND(0.2)
September	ND(50)	NA	ND(0.5)	ND(0.5)	ND(0.5)	ND(0.5)	87	ND	ND	ND(700)	ND(0.2)
April (06)	ND(50)	NA	ND(0.5)	ND(0.5)	ND(0.5)	ND(0.5)	53	ND	ND	ND(100)	ND(200)
September	ND(50)	NA	ND(0.5)	ND(0.5)	ND(0.5)	ND(0.5)	83	ND	ND	ND(100)	ND(200)
April (07)	ND(50)	NA	ND(0.5)	ND(0.5)	ND(0.5)	ND(0.5)	ND(48)	ND	1.6 Napth.	ND(100)	ND(0.2)
September	ND(50)	NA	ND(0.5)	ND(0.5)	ND(0.5)	ND(0.5)	ND(47)	ND	ND	ND(100)	ND(0.2)
February (08)	ND(50)	NA	ND(0.5)	ND(0.5)	ND(0.5)	ND(0.5)	140	ND	ND	ND(100)	ND(0.2)
August (08)	ND(50)	NA	ND(0.5)	ND(0.5)	ND(0.5)	ND(0.5)	ND(48)	ND	ND	2.4	ND(0.2)
January (09)	ND(50)	NA	ND(0.5)	ND(0.5)	ND(0.5)	ND(0.5)	ND(48)	ND	0.19	ND(100)	ND(0.2)
January (10)	ND(50)	NA	ND(0.5)	ND(0.5)	ND(0.5)	ND(0.5)	ND(50)	ND	ND	ND(5)	ND(0.2)
August (10)	ND(50)	NA	ND(0.5)	ND(0.5)	ND(0.5)	ND(1.5)	ND(50)	ND	ND	ND(5)	ND(0.2)
February (11)	ND(50)	NA	ND(0.5)	ND(0.5)	ND(0.5)	ND(1.5)	ND(50)	ND	ND	ND(5)	ND(0.2)
August (11)	ND(50)	NA	ND(0.5)	ND(0.5)	ND(0.5)	ND(1.5)	ND(50)	ND	ND	ND(5)	ND(0.2)
February (12)	ND(50)	NA	ND(0.5)	ND(0.5)	ND(0.5)	ND(1.5)	ND(50)	ND	ND	ND(5)	ND(0.2)
February (13)	ND(50)	NA	ND(0.3)	ND(0.3)	ND(0.5)	ND(0.5)	130	ND	ND	ND(5)	ND(1)
February (14)	ND(50)	NA	NA	NA	NA	NA	ND(50)	ND	ND	ND(5)	ND(1)
March (15)	ND(50)	NA	NA	NA	NA	NA	ND(50)	ND	ND	ND(50)	ND(1)
March (16)	ND(50)	NA	ND(0.3)	ND(0.3)	ND(0.5)	ND(0.5)	ND(250)	ND	ND	ND(1)	ND(0.001)
February (17)	ND(200)	NA	ND(0.083)	ND(0.093)	ND(0.098)	ND(0.36)	ND(34)	ND	ND	ND(4.0)	ND(0.030)
March (18)	Well Dry										

TABLE 4

HISTORICAL GROUNDWATER DATA
 "B" ZONE WELLS (1991-1993, 1995-2017)
 SAN JOSE ARENA
 (concentrations in µg/L)

Well ID	TPH-g	MTBE	Benzene	Toluene	Ethylbenzene	Total Xylenes	TPH-d	VOCs	PAHs	Lead	Mercury
Well ID	TPH-g	MTBE	Benzene	Toluene	Ethylbenzene	Total Xylenes	TPH-d	VOCs	PAHs	Lead	Mercury
MW-26											
March (91)	Well Not Installed Yet										
July	ND(50)	NA	ND(0.5)	ND(0.5)	ND(0.5)	ND(0.5)	ND	Chloroform(11.0)	ND	ND	ND
December	ND(50)	NA	ND(0.5)	ND(0.5)	ND(0.5)	ND(0.5)	ND	Chloroform(3.8)	ND	ND	ND
March (92)	ND(30)	NA	ND(0.3)	ND(0.3)	ND(0.3)	ND(0.3)	ND	ND	ND	ND	ND
August	ND(50)	NA	ND(0.5)	ND(0.5)	ND(0.5)	ND(0.5)	ND	ND	5.1	ND	ND
January (93)	ND(50)	NA	ND(0.5)	ND(0.5)	ND(0.5)	ND(0.5)	ND	ND	ND	ND	ND
June	ND(50)	NA	ND(0.5)	ND(0.5)	ND(0.5)	ND(0.5)	ND(50)	ND	ND	ND	ND
February (95)	ND(50)	NA	ND(0.5)	ND(0.5)	ND(0.5)	ND(0.5)	ND(100)	ND	ND	ND	ND
August	ND(50)	NA	ND(0.5)	ND(0.5)	ND(0.5)	ND(0.5)	64	ND	ND	ND	ND
March (96)	ND(50)	NA	ND(0.5)	ND(0.5)	ND(0.5)	ND(0.5)	160	ND	0.13	ND	ND
August	ND(50)	NA	ND(0.5)	ND(0.5)	ND(0.5)	ND(0.5)	ND	ND	ND	ND	ND
March (97)	ND(50)	NA	ND(0.5)	ND(0.5)	ND(0.5)	ND(0.5)	ND	ND	ND	2.7	0.030
March (98)	ND(50)	ND(10)	ND(0.3)	ND(0.3)	ND(0.3)	ND(0.6)	ND(50)	ND	ND	ND(0.1)	ND(0.2)
October	ND(50)	ND(10)	ND(0.3)	ND(0.3)	ND(0.3)	ND(0.6)	100	ND	ND	ND(0.1)	ND(0.2)
March (99)	ND(50)	ND(10)	ND(0.3)	ND(0.3)	ND(0.3)	ND(0.6)	ND	ND	ND	ND(0.1)	ND(0.2)
September	ND(50)	ND(10)	ND(0.3)	ND(0.3)	ND(0.3)	ND(0.6)	ND	ND	ND	ND(0.1)	ND(0.2)
March (00)	ND(50)	ND(10)	ND(0.3)	ND(0.3)	ND(0.3)	ND(0.6)	ND	ND	ND	ND(0.1)	ND(0.2)
August	ND(50)	2.4	ND(0.3)	ND(0.3)	ND(0.3)	ND(0.6)	ND	ND	ND	ND(0.1)	ND(0.2)
March (01)	ND(50)	ND(10)	ND(0.3)	ND(0.3)	ND(0.3)	ND(0.6)	ND	ND	ND	ND(0.1)	ND(0.2)
August	ND(50)	ND(10)	ND(0.3)	ND(0.3)	ND(0.3)	ND(0.6)	ND	ND	ND	ND(0.1)	ND(0.2)
February (02)	ND(50)	ND(10)	ND(0.3)	ND(0.3)	ND(0.3)	ND(0.6)	ND	ND	ND	ND(0.1)	ND(0.2)
August	ND(50)	ND(2.5)	ND(0.5)	ND(0.5)	ND(0.5)	ND(0.5)	ND(50)	ND	ND	ND(0.1)	ND(0.2)
March (03)	ND(50)	ND(2.0)	ND(0.5)	ND(0.5)	ND(0.5)	ND(0.5)	56	ND	ND	ND (0.1)	ND (0.2)
March (04)	ND(50)	ND(2.5)	ND(0.5)	ND(0.5)	ND(0.5)	ND(0.5)	120	ND	ND	ND (0.1)	ND (0.2)
September	ND(50)	ND(2.5)	ND(0.5)	ND(0.5)	ND(0.5)	ND(0.5)	ND(48)	ND	ND	ND(100)	ND(0.2)
March (05)	ND(50)	NA	ND(0.5)	ND(0.5)	ND(0.5)	ND(0.5)	9200	ND	ND	ND(100)	ND(0.2)
September	ND(50)	NA	ND(0.5)	ND(0.5)	ND(0.5)	ND(0.5)	ND(48)	ND	ND	ND(700)	ND(0.2)
April (06)	ND(50)	NA	ND(0.5)	ND(0.5)	ND(0.5)	ND(0.5)	ND(48)	ND	ND	ND(100)	ND(200)
September	ND(50)	NA	ND(0.5)	ND(0.5)	ND(0.5)	ND(0.5)	ND(48)	ND	ND	ND(100)	ND(200)
March (07)	ND(50)	NA	ND(0.5)	ND(0.5)	ND(0.5)	ND(0.5)	ND(47)	ND	3.1	ND(100)	ND(0.2)
September	ND(50)	NA	ND(0.5)	ND(0.5)	ND(0.5)	ND(0.5)	ND(49)	ND	63.20	ND(100)	ND(0.2)
February (08)	ND(50)	NA	ND(0.5)	ND(0.5)	ND(0.5)	ND(0.5)	ND(47)	ND	ND	ND(100)	ND(0.2)
August (08)	ND(50)	NA	ND(0.5)	ND(0.5)	ND(0.5)	ND(0.5)	ND(48)	ND	ND	ND(0.5)	ND(0.2)
January (09)	ND(50)	NA	ND(0.5)	ND(0.5)	ND(0.5)	ND(0.5)	ND(47)	ND	ND	ND(100)	ND(0.2)
January (10)	ND(50)	NA	ND(0.5)	ND(0.5)	ND(0.5)	ND(0.5)	ND(50)	ND	ND	ND(5)	ND(0.2)
August (10)	ND(50)	NA	ND(0.5)	ND(0.5)	ND(0.5)	ND(1.5)	ND(50)	ND	ND	ND(5)	ND(0.2)
February (11)	ND(50)	NA	ND(0.5)	ND(0.5)	ND(0.5)	ND(1.5)	ND(50)	ND	ND	ND(5)	ND(0.2)
August (11)	ND(50)	NA	ND(0.5)	ND(0.5)	ND(0.5)	ND(1.5)	ND(50)	ND	ND	ND(5)	ND(0.2)
February (12)	ND(50)	NA	ND(0.5)	ND(0.5)	ND(0.5)	ND(1.5)	ND(50)	ND	ND	ND (5)	ND (0.2)
February (13)	ND(50)	NA	ND(0.3)	ND(0.3)	ND(0.5)	ND(0.5)	51	ND	ND	ND (5)	ND (1)
February (14)	ND(50)	NA	NA	NA	NA	NA	ND(50)	ND	ND	ND (5)	ND (1)
March (15)	ND(50)	NA	NA	NA	NA	NA	ND(50)	ND	ND	ND (5)	ND (1)
March (16)	ND(50)	NA	ND (0.3)	ND (0.3)	ND(0.5)	ND(0.5)	ND(250)	ND	ND	ND (1)	ND (0.001)
February (17)	ND (200)	NA	ND (0.083)	ND (0.093)	ND (0.098)	ND (0.36)	ND (34)	ND	ND	ND (4.0)	ND (0.030)
March (18)	ND (5))	NA	ND 0.5)	ND 0.5)	ND (0.5)	ND (1.0)	ND (50)	ND	ND	4.7	ND (0.20)

TABLE 4

HISTORICAL GROUNDWATER DATA
 "B" ZONE WELLS (1991-1993, 1995-2017)
 SAN JOSE ARENA
 (concentrations in µg/L)

Well ID	TPH-g	MTBE	Benzene	Toluene	Ethylbenzene	Total Xylenes	TPH-d	VOCs	PAHs	Lead	Mercury
Well ID	TPH-g	MTBE	Benzene	Toluene	Ethylbenzene	Total Xylenes	TPH-d	VOCs	PAHs	Lead	Mercury
MW-31											
July (91)	ND(50)	NA	ND(0.5)	ND(0.5)	ND(0.5)	ND(0.5)	ND	ND	ND	ND	ND
December	ND(50)	NA	ND(0.5)	ND(0.5)	ND(0.5)	ND(0.5)	ND	ND	ND	1.4	ND
March (92)	ND(30)	NA	ND(0.3)	ND(0.3)	ND(0.3)	ND(0.3)	ND	ND	ND	ND	ND
August	ND(50)	NA	ND(0.5)	ND(0.5)	ND(0.5)	ND(0.5)	ND	ND	20	ND	ND
January (93)	ND(50)	NA	ND(0.5)	ND(0.5)	ND(0.5)	ND(0.5)	ND	ND	ND	ND	ND
June	ND(50)	NA	ND(0.5)	ND(0.5)	ND(0.5)	ND(0.5)	ND(100)	ND	ND	ND	ND
February (95)	2,500	NA	4.3	79	29	160	6,800*	ND	26.96	2.6	ND
August	6,000	NA	120	350	190	430	8800	DCM(22)	ND	ND	ND
March (96)	6,300	NA	ND	170	81	430	9200	ND	41.6	ND	ND
August	3,200	NA	ND	140	63	300	2300	ND	14.2	6.2	0.030
March (97)	9,500	NA	ND	220	150	790	3400	ND	69.915	23	0.070
March (98)	ND(50)	ND(10)	ND	3.4	2.0	5.3	ND	ND	ND	11	ND(0.2)
October	130	ND(10)	ND(0.3)	5.9	5.0	16	ND(50)	ND	ND	ND(0.1)	ND(0.2)
March (99)	55	ND(10)	ND(0.3)	4.0	3.5	10	ND(50)	ND	ND	ND(0.1)	ND(0.2)
September	ND(50)	ND(10)	ND(0.3)	3.9	5.0	13	ND(50)	ND	0.28**	ND(0.1)	ND(0.2)
March (00)	ND(50)	ND(10)	ND(0.3)	1.3	2.8	5.2	ND(50)	ND	ND	ND(0.1)	ND(0.2)
August	ND(50)	5.0	ND(0.3)	1.2	2.9	7	ND(50)	ND	ND	ND(0.1)	ND(0.2)
March (01)	ND(50)	ND(10)	ND(0.3)	0.54	2.1	4.6	ND(50)	ND	0.90 Napth.	ND(0.1)	ND(0.2)
August	ND(50)	ND(10)	ND(0.3)	0.63	2.9	4.9	ND(50)	ND	ND	ND(0.1)	0.45
February (02)	ND(50)	ND(10)	ND(0.3)	0.36	2.6	4.1	ND(50)	ND	ND	ND(0.1)	ND(0.2)
August	ND(50)	ND(2.5)	ND(0.5)	ND(0.5)	2.6	3.8	68	ND	ND	ND(0.1)	ND(0.2)
March (03)	ND(50)	ND(2.0)	ND(0.5)	ND(0.5)	0.87	1.3	85	ND	ND	ND (0.1)	ND (0.2)
March (04)	ND(50)	ND(2.5)	ND(0.5)	ND(0.5)	1.2	2.7	270	ND	ND	ND (0.1)	ND (0.2)
September	370	ND(0.5)	ND(0.5)	0.81	22.00	75.00	1200	Trimeth(1.2)	2.3**	ND(100)	ND(0.2)
March (05)	ND(50)	NA	ND(0.5)	ND(0.5)	0.65	0.94	150	ND	ND	ND(100)	ND(0.2)
September	ND(50)	NA	ND(0.5)	ND(0.5)	1.3	1.3	ND(49)	ND	ND	ND(700)	ND(0.2)
March (06)	ND(50)	NA	ND(0.5)	ND(0.5)	1.9	1	ND(48)	ND	0.69 Napth.	ND(100)	ND(200)
September	ND(50)	NA	ND(0.5)	ND(0.5)	ND(0.5)	ND(0.5)	ND(48)	ND	ND	ND(100)	ND(200)
March (07)	ND(50)	NA	ND(0.5)	ND(0.5)	ND(0.5)	ND(0.5)	ND(48)	ND	8.3	ND(100)	ND(0.2)
September	ND(50)	NA	ND(0.5)	ND(0.5)	ND(0.5)	ND(0.5)	ND(48)	58.1	0.89 Napth.	ND(100)	ND(0.2)
February (08)	ND(50)	NA	ND(0.5)	ND(0.5)	ND(0.5)	ND(0.5)	ND(51)	ND	ND	ND(100)	ND(0.2)
August (08)	ND(50)	NA	ND(0.5)	ND(0.5)	ND(0.5)	ND(0.5)	ND(50)	ND	ND	0.51	ND(0.2)
January (09)	440	NA	ND(0.5)	ND(0.5)	6.7	0.64	480	ND	ND	0.51	ND(0.2)
January (10)	ND(50)	NA	ND(0.5)	ND(0.5)	ND(0.5)	ND(0.5)	ND(50)	ND	ND	ND(5)	ND(0.2)
August (10)	ND(50)	NA	ND(0.5)	ND(0.5)	ND(0.5)	ND(1.5)	ND(50)	ND	ND	ND(5)	ND(0.2)
February (11)	ND(50)	NA	ND(0.5)	ND(0.5)	ND(0.5)	ND(1.5)	ND(50)	ND	ND	ND(5)	ND(0.2)
August (11)	ND(50)	NA	ND(0.5)	ND(0.5)	ND(0.5)	ND(1.5)	ND(50)	ND	ND	ND(5)	ND(0.2)
February (12)	ND(50)	NA	ND(0.5)	ND(0.5)	ND(0.5)	ND(1.5)	ND(50)	ND	ND	ND (5)	ND (0.2)
February (13)	ND(50)	NA	ND(0.3)	ND(0.3)	ND(0.5)	ND(0.5)	ND(50)	ND	ND	ND(5)	ND(1)
February (14)	ND(50)	NA	NA	NA	NA	NA	ND(50)	ND	ND	ND(5)	ND(1)
March (15)	ND(50)	NA	NA	NA	NA	NA	ND(250)	ND	ND	ND(50)	ND(1)
March (16)	ND(50)	NA	ND (0.3)	ND (0.3)	ND(0.5)	ND(0.5)	ND(250)	ND	ND	ND (1)	ND (0.001)
February (17)	ND (200)	NA	ND (0.083)	ND (0.093)	ND (0.098)	ND (0.36)	ND (34)	0.18	ND	ND (4.0)	ND (0.030)
March (18)	Well Dry										

TABLE 4

HISTORICAL GROUNDWATER DATA
 "B" ZONE WELLS (1991-1993, 1995-2017)
 SAN JOSE ARENA
 (concentrations in µg/L)

Well ID	TPH-g	MTBE	Benzene	Toluene	Ethylbenzene	Total Xylenes	TPH-d	VOCs	PAHs	Lead	Mercury
Well ID	TPH-g	MTBE	Benzene	Toluene	Ethylbenzene	Total Xylenes	TPH-d	VOCs	PAHs	Lead	Mercury
MW-33											
March (91)	Well Could Not Be Sampled										
July	Well Could Not Be Sampled										
December	Well Could Not Be Sampled										
March (92)	Well Could Not Be Sampled										
August	Well Could Not Be Sampled										
January (93)	Well Could Not Be Sampled										
June	Well Could Not Be Sampled										
February (95)	ND(50)	NA	ND(0.5)	ND(0.5)	ND(0.5)	ND(0.5)	ND(100)	ND	ND	5.2	ND
August	ND(50)	NA	ND(0.5)	ND(0.5)	ND(0.5)	ND(0.5)	130	ND	ND	ND	ND
March (96)	ND(50)	NA	ND(0.5)	ND(0.5)	ND(0.5)	ND(0.5)	120	ND	ND	ND	ND
August	ND(50)	NA	ND(0.5)	ND(0.5)	ND(0.5)	ND(0.5)	99	ND	ND	ND	ND
March (97)	ND(50)	NA	ND(0.5)	ND(0.5)	ND(0.5)	ND(0.5)	ND(100)	ND	ND	22	0.020
March (98)	ND(50)	ND(10)	ND(0.3)	ND(0.3)	ND(0.3)	ND(0.6)	ND(50)	ND	ND	ND(0.1)	ND(0.2)
October	ND(50)	ND(10)	ND(0.3)	ND(0.3)	ND(0.3)	ND(0.6)	ND(50)	ND	ND	ND(0.1)	ND(0.2)
March (99)	ND(50)	ND(10)	ND(0.3)	ND(0.3)	ND(0.3)	ND(0.6)	ND(50)	ND	ND	ND(0.1)	ND(0.2)
September	ND(50)	ND(10)	ND(0.3)	ND(0.3)	ND(0.3)	ND(0.6)	ND(50)	ND	ND	ND(0.1)	ND(0.2)
March (00)	ND(50)	ND(10)	ND(0.3)	ND(0.3)	ND(0.3)	ND(0.6)	ND(50)	ND	ND	ND(0.1)	ND(0.2)
August	ND(50)	1.5	ND(0.3)	ND(0.3)	ND(0.3)	ND(0.6)	ND(50)	ND	ND	ND(0.1)	ND(0.2)
March (01)	ND(50)	ND(10)	ND(0.3)	ND(0.3)	ND(0.3)	ND(0.6)	ND(50)	ND	ND	ND(0.1)	ND(0.2)
August	ND(50)	ND(10)	ND(0.3)	ND(0.3)	ND(0.3)	ND(0.6)	ND(50)	ND	ND	ND(0.1)	ND(0.2)
February (02)	ND(50)	2.1	ND(0.3)	ND(0.3)	ND(0.3)	ND(0.6)	ND(50)	ND	ND	ND(0.1)	ND(0.2)
August	ND(50)	ND(2.5)	ND(0.5)	ND(0.5)	ND(0.5)	ND(0.5)	ND(50)	ND	ND	16	ND0.2
March (03)	ND(50)	ND(2.0)	ND(0.5)	ND(0.5)	ND(0.5)	ND(0.5)	110	ND	ND	ND (0.1)	ND (0.2)
March (04)	ND(50)	ND(2.5)	ND(0.5)	ND(0.5)	ND(0.5)	ND(0.5)	110	ND	ND	ND (0.1)	ND (0.2)
September	ND(50)	ND(0.5)	ND(0.5)	ND(0.5)	ND(0.5)	ND(0.5)	ND(48)	ND	ND	ND(100)	ND(0.2)
March (05)	ND(50)	NA	ND(0.5)	ND(0.5)	ND(0.5)	ND(0.5)	240	ND	1.8 Naph	ND(100)	ND(0.2)
September	ND(50)	NA	ND(0.5)	ND(0.5)	ND(0.5)	ND(0.5)	ND(49)	ND	16.63	ND(700)	ND(0.2)
April (06)	ND(50)	NA	ND(0.5)	ND(0.5)	ND(0.5)	ND(0.5)	ND(48)	ND	ND	ND(100)	ND(200)
September	ND(50)	NA	ND(0.5)	ND(0.5)	ND(0.5)	ND(0.5)	ND(48)	ND	2.1 Naph	ND(100)	ND(200)
March (07)	ND(50)	NA	ND(0.5)	ND(0.5)	ND(0.5)	ND(0.5)	ND(49)	ND	ND	ND(100)	ND(0.2)
September	ND(50)	NA	ND(0.5)	ND(0.5)	ND(0.5)	ND(0.5)	ND(48)	ND	2.5 Naph	ND(100)	ND(0.2)
February (08)	ND(50)	NA	ND(0.5)	ND(0.5)	ND(0.5)	ND(0.5)	ND(51)	ND	ND	ND(100)	ND(0.2)
August (08)	ND(50)	NA	ND(0.5)	ND(0.5)	ND(0.5)	ND(0.5)	ND(50)	ND	ND	ND(0.5)	ND(0.2)
January (09)	ND(50)	NA	ND(0.5)	ND(0.5)	ND(0.5)	ND(0.5)	ND(47)	ND	ND	ND(0.5)	ND(0.2)
January (10)	ND(50)	NA	ND(0.5)	ND(0.5)	ND(0.5)	ND(0.5)	ND(50)	ND	ND	ND(5)	ND(0.2)
August (10)	ND(50)	NA	ND(0.5)	ND(0.5)	ND(0.5)	ND(1.5)	ND(50)	ND	ND	ND(5)	ND(0.2)
February (11)	ND(50)	NA	ND(0.5)	ND(0.5)	ND(0.5)	ND(1.5)	ND(50)	ND	ND	ND(5)	ND(0.2)
August (11)	ND(50)	NA	ND(0.5)	ND(0.5)	ND(0.5)	ND(1.5)	ND(50)	ND	ND	ND(5)	ND(0.2)
February (12)	ND(50)	NA	ND(0.5)	ND(0.5)	ND(0.5)	ND(1.5)	ND(50)	ND	ND	ND (5)	ND (0.2)
February (13)	ND(50)	NA	ND(0.3)	ND(0.3)	ND(0.5)	ND(0.5)	ND(50)	ND	ND	ND(5)	ND(1)
February (14)	ND(50)	NA	NA	NA	NA	NA	ND(50)	ND	ND	ND(5)	ND(1)
March (15)	ND(50)	NA	NA	NA	NA	NA	ND(250)	ND	ND	ND(50)	ND(1)
March (16)	ND(50)	NA	ND (0.3)	ND (0.3)	ND(0.5)	ND(0.5)	ND(250)	ND	ND	ND (1)	ND (0.001)
February (17)	ND (200)	NA	ND (0.083)	ND (0.093)	ND (0.098)	ND (0.36)	ND (34)	ND	0.16	ND (4.0)	ND (0.030)
March (18)	ND (50)	NA	ND 0.5)	ND 0.5)	ND (0.5)	ND (1.0)	ND (50)	ND	ND	4.1	ND (0.20)

TABLE 4

HISTORICAL GROUNDWATER DATA
 "B" ZONE WELLS (1991-1993, 1995-2017)
 SAN JOSE ARENA
 (concentrations in µg/L)

Well ID	TPH-g	MTBE	Benzene	Toluene	Ethylbenzene	Total Xylenes	TPH-d	VOCs	PAHs	Lead	Mercury
Well ID	TPH-g	MTBE	Benzene	Toluene	Ethylbenzene	Total Xylenes	TPH-d	VOCs	PAHs	Lead	Mercury
GW-1B											
March (91)	ND(50)	NA	ND(0.5)	ND(0.5)	ND(0.5)	ND(0.5)	ND	ND	0.14	1.4	ND
July	ND(50)	NA	ND(0.5)	ND(0.5)	ND(0.5)	ND(0.5)	ND	ND	ND	ND	ND
December	ND(50)	NA	ND(0.5)	ND(0.5)	ND(0.5)	ND(0.5)	ND	ND	0.078	ND	ND
March (92)	ND(30)	NA	ND(0.3)	ND(0.3)	ND(0.3)	ND(0.3)	ND	ND	ND	ND	ND
August	ND(50)	NA	ND(0.5)	ND(0.5)	ND(0.5)	ND(0.5)	ND	ND	ND	ND	ND
January (93)	ND(50)	NA	ND(0.5)	ND(0.5)	ND(0.5)	ND(0.5)	ND	ND	ND	ND	ND
June	ND(50)	NA	ND(0.5)	ND(0.5)	ND(0.5)	ND(0.5)	ND(50)	ND	0.037	ND	ND
February (95)	ND(50)	NA	ND(0.5)	ND(0.5)	ND(0.5)	0.61	150*	ND	1.55	1.1	ND
August	ND(50)	NA	ND(0.5)	ND(0.5)	ND(0.5)	ND(0.5)	350	ND	ND	ND	ND
March (96)	ND(50)	NA	ND(0.5)	ND(0.5)	ND(0.5)	ND(0.5)	810	ND	2.86	ND	ND
August	ND(50)	NA	ND(0.5)	ND(0.5)	ND(0.5)	ND(0.5)	540	ND	1.1	ND	ND
March (97)	ND(50)	NA	0.70	ND(0.5)	ND(0.5)	ND(0.5)	150	ND	ND	1.9	0.060
March (98)	ND(50)	3.8	0.46	1.0	0.37	2	270	ND	ND	ND(0.1)	ND(0.2)
October	ND(50)	ND(10)	ND(0.3)	ND(0.3)	ND(0.3)	ND(0.6)	130	ND	ND	5.9	0.20
March (99)	ND(50)	ND(10)	ND(0.3)	ND(0.3)	ND(0.3)	ND(0.6)	54	ND	ND	ND(0.1)	ND(0.2)
September	ND(50)	ND(10)	ND(0.3)	0.84	ND(0.3)	ND(0.6)	ND	ND	ND	ND(0.1)	ND(0.2)
March (00)	ND(50)	ND(10)	ND(0.3)	ND(0.3)	ND(0.3)	ND(0.6)	ND	ND	ND	ND(0.1)	ND(0.2)
August	ND(50)	ND(10)	ND(0.3)	ND(0.3)	ND(0.3)	ND(0.6)	ND	ND	ND	ND(0.1)	ND(0.2)
March (01)	ND(50)	ND(10)	ND(0.3)	ND(0.3)	ND(0.3)	ND(0.6)	ND	ND	ND	ND(0.1)	ND(0.2)
August	ND(50)	ND(10)	ND(0.3)	ND(0.3)	ND(0.3)	ND(0.6)	ND	ND	ND	ND(0.1)	ND(0.2)
February (02)	ND(50)	ND(10)	ND(0.3)	ND(0.3)	ND(0.3)	ND(0.6)	ND	ND	ND	ND(0.1)	ND(0.2)
August	ND(50)	ND(2.5)	ND(0.5)	ND(0.5)	ND(0.5)	ND(0.5)	72	ND	ND	ND(0.1)	ND(0.2)
March (03)	ND(50)	ND(2.0)	ND(0.5)	ND(0.5)	ND(0.5)	ND(0.5)	60	ND	ND	ND(0.1)	ND(0.2)
March (04)	ND(50)	ND(2.5)	ND(0.5)	ND(0.5)	ND(0.5)	ND(0.5)	150	ND	ND	ND(0.1)	ND(0.2)
September	ND(50)	ND(2.5)	ND(0.5)	ND(0.5)	ND(0.5)	ND(0.5)	83	ND	ND	ND(100)	ND(0.2)
March (05)	ND(50)	NA	ND(0.5)	ND(0.5)	ND(0.5)	ND(0.5)	260	ND	5.5 Naph	ND(100)	ND(0.2)
September	ND(50)	NA	ND(0.5)	ND(0.5)	ND(0.5)	ND(0.5)	ND(49)	ND	2.7	ND(100)	ND(0.2)
April (06)	ND(50)	NA	ND(0.5)	ND(0.5)	ND(0.5)	ND(0.5)	ND(48)	ND	ND	ND(100)	ND(200)
September	ND(50)	NA	ND(0.5)	ND(0.5)	ND(0.5)	ND(0.5)	ND(49)	ND	0.32 Naph	ND(100)	ND(200)
March (07)	ND(50)	NA	ND(0.5)	ND(0.5)	ND(0.5)	ND(0.5)	ND(49)	ND	ND	ND(100)	ND(0.2)
September	ND(50)	NA	ND(0.5)	ND(0.5)	ND(0.5)	ND(0.5)	ND(48)	1.9 MethCl	ND	ND(100)	ND(0.2)
February (08)	ND(50)	NA	ND(0.5)	ND(0.5)	ND(0.5)	ND(0.5)	ND(50)	ND	ND	ND(100)	ND(0.2)
August (08)	ND(50)	NA	ND(0.5)	ND(0.5)	ND(0.5)	ND(0.5)	ND(49)	ND	ND	ND(0.5)	ND(0.2)
January (09)	ND(50)	NA	ND(0.5)	ND(0.5)	ND(0.5)	ND(0.5)	ND(47)	ND	ND	ND(0.5)	ND(0.2)
January (10)	ND(50)	NA	ND(0.5)	ND(0.5)	ND(0.5)	ND(0.5)	ND(50)	ND	ND	ND(5)	ND(0.2)
August (10)	ND(50)	NA	ND(0.5)	ND(0.5)	ND(0.5)	ND(0.5)	ND(50)	ND	ND	ND(5)	ND(0.2)
February (11)	ND(50)	NA	ND(0.5)	ND(0.5)	ND(0.5)	ND(0.5)	ND(50)	ND	ND	ND(5)	ND(0.2)
August (11)	ND(50)	NA	ND(0.5)	ND(0.5)	ND(0.5)	ND(0.5)	ND(50)	ND	ND	ND(5)	ND(0.2)
February (12)	ND(50)	NA	ND(0.5)	ND(0.5)	ND(0.5)	ND(1.5)	ND(50)	ND	ND	ND(5)	ND(0.2)
February (13)	ND(50)	NA	ND(0.3)	ND(0.3)	ND(0.5)	ND(0.5)	ND(50)	ND	ND	ND(5)	ND(1)
February (14)	ND(50)	NA	NA	NA	NA	NA	ND(50)	ND	ND	ND(5)	ND(1)
March (15)	ND(50)	NA	NA	NA	NA	NA	ND(50)	ND	ND	ND(50)	ND(1)
March (16)	ND(50)	NA	ND(0.3)	ND(0.3)	ND(0.5)	ND(0.5)	ND(250)	ND	ND	ND(1)	ND(0.001)
February (17)	ND(200)	NA	ND(0.083)	ND(0.093)	ND(0.098)	ND(0.36)	ND(34)	ND	ND	ND(4.0)	ND(0.030)
March (18)	Well Dry										

Notes:

- * - Chromatogram pattern is not indicative of analyte in question.
- ** - Discrete peaks not diesel.
- TPH-g - Total Petroleum Hydrocarbons as Gasoline.
- TPH-d - Total Petroleum Hydrocarbons as Diesel.
- MTBE - Methyl Tertiary Butyl Ether
- EPA-8010 - Halogenated Volatile Organic Chemicals.
- EPA-8310 - Polynuclear Aromatics
- ND(##) - Not Detected at detection limits in parentheses (parts per billion - ppb)
- ND - Not Detected
- NA - Not Analyzed