

P-43-001316

P-43-001316

This Primary Number has been voided because two Primary numbers were inadvertently assigned to the same resource. Please see the following corrected Primary file numbers:

P-43-001874

10April 2009
Leigh Jordan, Coordinator NWIC

State of California - The Resources Agency
DEPARTMENT OF PARKS AND RECREATION
PRIMARY RECORD

Primary # P-43-001874
HRI #
Trinomial
NRHP Status Code

Other Listings
Review Code

Reviewer

Date

Page 1 of 3 *Resource Name or # (Assigned by recorder): Owen House

P1. Other identifier: None

*P2. Location: ☐ Not for Publication ☒ Unrestricted

*a. County Santa Clara

and (P2b and P2c or P2d. Attach a location map as necessary.)

*b. USGS 7.5' Quad San Jose West

Date 1980 photo revised T .7S. ; R .1E. ; Mount Diablo B.M.

c. Address: 398 San Fernando St., West

City San Jose

Zip 95110

d. UTM:(give more than one for large and/or linear resources)

Zone 10S ; 597632

mE/ 4132045

mN

e. Other Locational Data: (e.g., parcel #, directions to resource, elevation, etc., as appropriate)

Southeast corner of West San Fernando Street and Delmas Avenue

APN# 259-45-029

*P3a. Description: (Describe resource and its major elements, include design, material, condition, alterations, size, setting, and boundaries)

This elaborate Queen Anne house helps establish the character of the Lakehouse neighborhood. It illustrates, through its form and detailing, the cohesive, well-defined pattern of development of this residential neighborhood adjacent to San Jose's downtown core.

This north-facing corner house has similar massing to other houses in the Lakehouse neighborhood, but its form is more vertical in orientation and more complex. A raised, two-story, rectangular main mass with a moderately pitched hipped roof is accented by projecting gables to the front and west side; this typical Queen Anne plan is enhanced by a tall square tower at the outside corner. Entry is through a projecting porch that shares its full-width shed roof with a front square bay window. As standard for the period and the neighborhood, the eaves are moderate in depth and boxed, without original gutters; however, the soffits on this house follow the rafter pitch; they are not horizontal as usual. The typical v-groove siding is trimmed by flat-boards at the corners, watertable apron, frieze board under the eaves, and window side and header casings. Fenestration on the sides of the house is generally 1/1 double hung windows, with basement-level windows visible in the pony wall above the foundation. The rear of the house features a one-and-one-half story addition or modified one-story original wing.
(See page 3, Continuation sheet)

*P3b. Resource Attributes: (List attributes and codes) HP2. Single family property

*P4. Resources Present: ☒ Building ☐ Structure ☐ Object ☐ Site ☒ District ☐ Element of District ☐ Other (Isolates, etc.)



P5b. Description of Photo:

(View, date, accession #)

View facing east, 12/05

*P6. Date Constructed/Age and Source:

☒ Historic ☐ Prehistoric ☐ Both

1888, assessment records, 118 years old.

*P7. Owner and Address:

MICHAEL A. NOCE
PO BOX 896
BEN LOMOND CA 95005

*P8. Recorded By: (Name, affiliation, and address)

C. Duval, L. Dill & F. Maggi

Archives & Architecture
PO Box 1332
San Jose CA 95109

*P9. Date Recorded: 5/26/06

*P10. Survey Type: (Describe)

Intensive

*P11. Report Citation: (Cite survey report and other sources, or enter "none".)

Archives & Architecture, Historic District Study - Lake House Neighborhood, prepared for the City of San Jose, April 28, 2006.

*Attachments:

☐ None

☒ Continuation Sheet

☒ District Record

☐ Rock Art Record

☐ Other (List):

☐ Location Map

☒ Building, Structure, and Object Record

☐ Linear Feature Record

☐ Artifact Record

☐ Sketch Map

☐ Archaeological Record

☐ Milling Station Record

☐ Photograph Record

DPR 523A (1/95)

* Required Information

6

BUILDING, STRUCTURE, AND OBJECT RECORD

Page 2 of 3

*NRHP/CRHR Status Code 5D2

Resource Name (Assigned by recorder) Owen House

B1. Historic Name: Clifford Owen House

B2. Common Name: 398 West San Fernando St.

B3. Original Use: Residential

B4. Present Use: Residential

*B5. Architectural Style: Queen Anne

*B6. Construction History: (Construction date, alterations, and date of alterations)

Constructed 1888.

*B7. Moved? ☒ No ☐ Yes ☐ Unknown Date: n/a

Original Location: n/a

*B8. Related Features:

None

B9a. Architect: Unknown

b. Builder: Unknown

*B10. Significance: Theme Architecture and Shelter

Area: Delmas Park SNI

Period of Significance: 1885-1925

Property Type: Residential

Applicable Criteria: 1, 2, 3

(Discuss importance in terms of historical or architectural context as defined by theme, period and geographic scope. Also address integrity.)

This house was built in 1888 for Clifford J. Owen, the son of San Jose Mercury publisher J. J. Owen. The property was within the Original City on a part of the 1862 Delmas Survey. J. J. Owen came to California in the 1850s, bringing his family to San Jose in 1862. J. J. Owen was the founder of the San Jose Mercury newspaper in 1862. After a distinguished career as San Jose's leading journalist, he sold the Mercury to Charles Shortridge in 1884. Born in New York in 1851, Owen's eldest son stayed with the Mercury after it was sold and served as both its assistant editor and president until 1899. In 1900, the house was owned by Charles Snostring, also a journalist. About 1906, the house was acquired by Charles F. Gillespie, who was the Vice President of the United States Laundry in 1909. Charles' father, lumbermill owner T. J. Gillespie, lived a half block west on the north side of West San Fernando Street. His widow, Mary Gillespie occupied the house in until 1924. By 1925, this was the home of Marie and Severio Sciafani. Severio built an addition to the house that served as a market, addressed as 102/104 Delmas Avenue. In the 1934, Severio operated a grocery store and Salvadore Mandala operated a meat market at this location. Mary Sciafani remained at this address until 1940 and the store became a liquor store operated by F. Aiassa through 1950.

This residential property contributes to the locally significant Lake House City Landmark Historic District; its form and detailing are distinctive within the neighborhood. As one of the earliest buildings in the neighborhood, it maintains integrity to the residential design and patterns of neighborhood development prior to 1926, and helps establish the character of the district.

B11. Additional Resource Attributes: (list attributes and codes) None

*B12. References:

(Continued on next page, Continuation sheet)

(Sketch Map with north arrow required.)

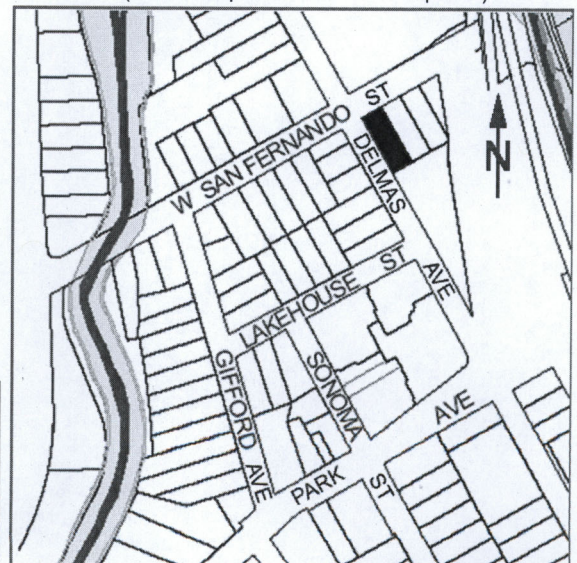
B13. Remarks: Contributor to Lake House Historic District.
Existing classification(s): none

*B14. Evaluator: Franklin Maggi

*Date of Evaluation: May 26, 2006

(This space reserved for official comments.)

State of California - The Resources Agency
DEPARTMENT OF PARKS AND RECREATION
CONTINUATION SHEET

Primary # P-43-001874
HRI #
Trinomial

Page 3 of 3 *Resource Name or # (Assigned by recorder) Owen House

*Recorded By C. Duval, L. Dill & F. Maggi

*Date 5/26/2006 ☒ Continuation ☐ Update

(Continued from page 1, DPR523a, P3a)

The setting includes a modest front yard with a picket fence at the sidewalk; a driveway enters the rear of the property from Delmas Avenue, at the west side of the property, where there is a detached one-car garage.

Special detailing that distinguishes this house includes its prominent tower with its steeply pitched, bell-cast hipped roof. Octagonal hoods protect oculus dormer windows in the tower roof. Above the second-story tower windows are panels with built-up sunbursts; to their sides are panels filled with diagonal siding. A high zone of decoratively cut shingled siding accentuates the upper walls, these end at the midpoint of the second-story window sides. At this line corbels and lowered blocks have been applied to the window casings. Decorative hoods protect the second-story windows; the center of each features a raised rosette. Bargeboards at the gable ends are carved with a vine pattern around inset rosettes. Behind the bargeboards are round attic vents. Other special detailing is visible on this house, including jigsaw window aprons and delicate roof finials at the gable ends and at the apex of the tower.

The porch has turned posts that square-off at their bases and tops; these support a spindlework spandrel and handrail. The railing has wide, flat arches created from thin, carved corbels; these are centered above a square grid of 2x2s that includes a finialled half-baluster below the arch. The front door is set into the main front wall, to the side of the projecting wing. The door has three narrow arched lites and a pattern of paneled squares below. A matching porch is faces west at the rear portion of the house; its roof continues the pitch of the steep roof.

(Continued from page 2, DPR523b, B12)

Arbuckle, C., *Clyde Arbuckle's History of San Jose*, 1985.

Foote, H. S., *Pen Pictures from the Garden of the World of Santa Clara County California*, 1888.

Hill & Laffey, DPR523, 1999.

San Jose Mercury, *Santa Clara County and its Resources: A Souvenir of the San Jose Mercury*, 1896, Photograph: (1896:313)

San Jose Assessor's Block Books, 1883-1924.

Santa Clara County Great Registers, 1867-1896.

San Jose City Directories, 1880-1970.

Sanborn Fire Insurance Map Co., San Jose, 1884-1966.

State of California – The Resources Agency
DEPARTMENT OF PARKS AND RECREATION
PRIMARY RECORD

Primary # P-43-001316

HRI # _____

Trinomial _____

NRHP Status Code _____

Other Listings _____

Review Code _____ Reviewer _____

Date _____

Page 1 of 4

Resource Name or #: (assigned by recorder) 398 W. San Fernando Street

P1. Other Identifier: _____ Ref. No. 16

P2. Location: ☐ Not for Publication ☒ Unrestricted and (P2b and P2c or P2d. Attach a Location Map as necessary)

a. County Santa Clara

b. USGS 7.5' Quad San Jose West (4273) Date 1980 T 7S R 1E; - $\frac{1}{4}$ of - $\frac{1}{4}$ of Sec. unsectioned; Mount Diablo B.M.

c. Address 398 W. San Fernando Street City San Jose Zip 95110

d. UTM: Zone 10; _____ mE / _____ mN

e. Other Locational Data: (e.g., parcel #, directions to resource, elevation, etc.)

APN 259-45-029

P3a. Description (Describe the resource and its major elements. Include design, materials, condition, alterations, size, setting & boundaries):

This two-story Queen Anne style house faces north on a conspicuous corner parcel in a neighborhood of Victorian residences. The house has been converted to apartments. Landscaping is minimal; a portion of the yard is used for parking cars, and there is a small, hip-roofed garage at the rear. The wood-frame house has a generally rectangular plan and a gable roof with overhanging eaves. There is a gabled bay on the west side, a gabled rear wing with recessed porch, and a prominent corner tower with steep pyramidal roof. A shed-roofed porch extends across the front, incorporating a rectangular bay window. The tall windows are wood-sash and double-hung, often grouped in pairs. Round windows with leaded panes are set in the gables, and there are round dormers on the tower. Wood ornament includes decorative shingles on the upper story, turned posts and a spindled frieze on the front porch, sunburst panels on the tower, crown molding on some windows, gable braces with incised panels, and a dentil molding under the eaves. The house appears unaltered except for the entry area, which was rebuilt when a small storefront addition was removed. The alterations include modern brick stairs, a modern door, and infill of vertical wood siding.

P3b. Resource Attributes: HP3—Multiple family property

P4. Resources present: ☒ Building ☐ Structure ☐ Object ☐ Site ☐ District ☐ Element of District ☐ Other

P5a. Photo or Drawing

(see continuation sheet)

P5b. Description of Photo: _____

P6. Date Constructed/Age and Sources:

☒ Historic ☐ Prehistoric ☐ Both
1888

P7. Owner and Address

Noce Janet A & Michael A

PO Box 896

Ben Lomond CA 95005

P8. Recorded by:

(Name, affiliation, and address)

Ward Hill and Glory Anne Laffey,

Archives and Architecture,

353 Surber Drive,

San Jose, CA 95123

P9. Date Recorded February 1999

P10. Survey Type: (Describe)

Intensive for Light Rail Corridor

P11. Report Citation (Cite survey report and other sources, or enter "none"):

Historic Properties Survey Report – Santa Clara Valley Transportation Authority Vasona Light Rail Corridor by Basin Research Associates, Archives and Architecture and W. Hill

Attachments: ☐ NONE ☐ Location Map ☐ Sketch Map ☒ Continuation Sheet ☒ Building, Structure and Object Record
☐ Archaeological Record ☐ District Record ☐ Linear Feature Record ☐ Milling Station Record ☐ Rock Art Record ☐ Artifact Record
☒ Photograph Record ☐ Other (List) _____

State of California – The Resources Agency
DEPARTMENT OF PARKS AND RECREATION
BUILDING, STRUCTURE AND OBJECT RECORD

Primary # P-43-001316

HRI # _____

NRHP Status Code _____

Page 2 of 4

Resource Name or #: (assigned by recorder) 398 W. San Fernando Street

B1. Historic Name: _____

B2. Common Name: _____

B3. Original Use: Residence

B4. Present Use: Residence

B5. Architectural Style: Queen Anne

B6. Construction History: (Construction date, alterations, and date of alterations)

The house has been converted to apartments. The house appears unaltered except for the entry area, which was rebuilt when a small storefront addition was removed. The alterations include modern brick stairs, a modern door, and infill of vertical wood siding.

B7. Moved? ☒ No ☐ Yes ☐ Unknown Date: _____ Original Location: _____

B8. Related Features: _____

B9a. Architect: Unknown

B9b. Builder: Unknown

B10. Significance: Theme Domestic Architecture Area San Jose

Period of Significance 1888-1900 Property Type Residential Applicable Criteria C

(Discuss importance in terms of historical or architectural context as defined by theme, period and geographic scope. Also address integrity.)

This house was built in 1888 for Clifford J. Owen, the eldest son of San Jose Mercury publisher J.J. Owen. J.J. Owen came to California in the 1850s and in 1862 brought his family to San Jose in 1862, the same year J.J. Owen also founded the San Jose Mercury newspaper. After a distinguished career as San Jose's leading journalist, he sold the Mercury to Charles Shortridge in 1884. Clifford J. Owen, born in New York in 1851, was with the Mercury after it was sold and served as both assistant editor and president until 1899.

About 1906 the house was acquired by Charles F. Gillespie, the Vice President of the United States Laundry in 1909. His widow, Mary Gillespie occupied the house until 1924. By 1925, the residence was the home of Marie and Severio Sciafani. Severio's market was attached to the house at 102/104 Delmas Avenue. In the 1934, Severio operated a grocery store and Salvadore Mandals operated a meat market at this location. Mary Sciafani remained at this address until 1940 and the store/market was replaced by liquor store operated by F. Aiassa through 1950. In subsequent years, the house changed hands several times and was vacant through much of the 1960s and 1970s.

398 W. San Fernando Street appears to retain a high level of historic integrity. With its distinctive corner tower and flanking steep gables, this house is an exceptional example of the Queen Anne style in San Jose. The house appears to be individually eligible for the National Register under Criterion C. While J.J. Owen as the founder of the *San Jose Mercury News* appears to have been a significant figure in local journalism, his son Clifford (who lived at 398 W. San Fernando Street) does not appear to be a significant figure in local history. The other occupants of the house also do not appear to be of historic significance. Consequently, the house at 398 W. San Fernando Street does not appear to be eligible under Criterion B. The house is not related to any significant historic themes under Criteria A.

In conclusion, 398 W. San Fernando Street appears to be individually eligible for the National Register because it appears to be significant under Criteria C. The house also appears to be a contributing structure to the potentially National Register eligible residential historic district in the Delmas area.

B11. Additional Resource Attributes: (List attributes and codes)

B12. References:

Anonymous (various authors) 1973-1974 Visual Inventory of Historic and Archaeological Sites, San Jose, California.
Arbuckle, C. 1985 Clyde Arbuckle's History of San Jose. San Jose: Smith & McKay Printing Company.
(see continuation sheet)

B13. Remarks:

B14. Evaluator Ward Hill, Architectural Historian and Glory Anne Laffey, Historian

Date of Evaluation: February 1999

(This space reserved for official comments)

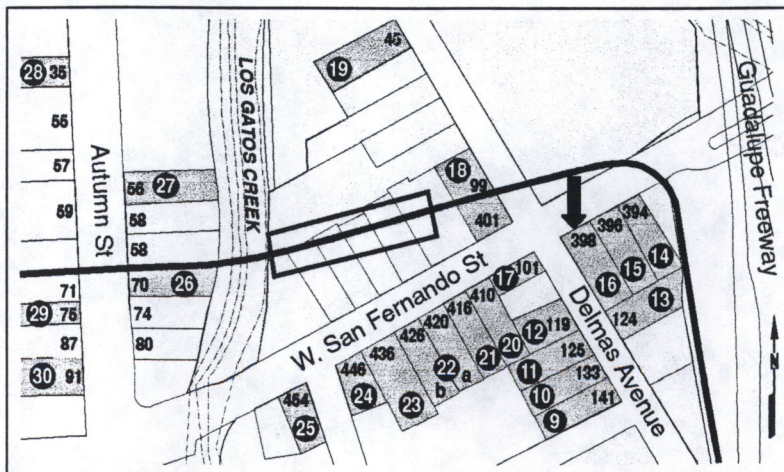

a.

State of California – The Resources Agency
DEPARTMENT OF PARKS AND RECREATION
CONTINUATION SHEET

Primary # P-43-001316
HRI # _____
Trinomial _____

Page 3 of 4 Resource Name or #: (assigned by recorder) 398 W. San Fernando Street
Recorded by Ward Hill and Glory Anne Laffey Date: February 1999 ☒ Continuation ☐ Update

Item B12. Continued

Basin Research Associates, Inc. and M.R. Corbett, 1997, Preliminary Review Vasona Corridor Historic Preservation Services Delmas Avenue Alternative, City of San Jose, Santa Clara County, California. For Santa Clara Valley Transportation Authority, 3331 North First Street, Building B, San Jose, CA 95134-1906. Sent to California Archaeological Site Inventory, Rohnert Park. Attn: Julie Klingmann, Dated June 26, 1997.

San Jose Assessor's Block Books, 1883-1924, Various books.

San Jose City Directories, 1880-1970, Various editions.

San Jose Mercury, 1896, Santa Clara County and its Resources: A Souvenir of the San Jose Mercury [Sunshine, Fruit, and Flowers]. San Jose: San Jose Mercury Publishing and Printing Co.

Sanborn Fire Insurance Maps for San Jose, 1884-1966, Various years.

Santa Clara County Great Registers, 1867-1896, Various registers.

Photograph Sunshine, Fruit and Flowers (1896:313)

State of California – The Resources Agency
DEPARTMENT OF PARKS AND RECREATION
CONTINUATION SHEET

Primary # P-43-001316

HRI # _____

Trinomial _____

Page 4 of 4

Resource Name or #: (assigned by recorder) 398 W. San Fernando Street

Recorded by Ward Hill and Glory Anne Laffey

Date: February 1999

☒ Continuation

☐ Update

Item P5a. Photo, continued

